

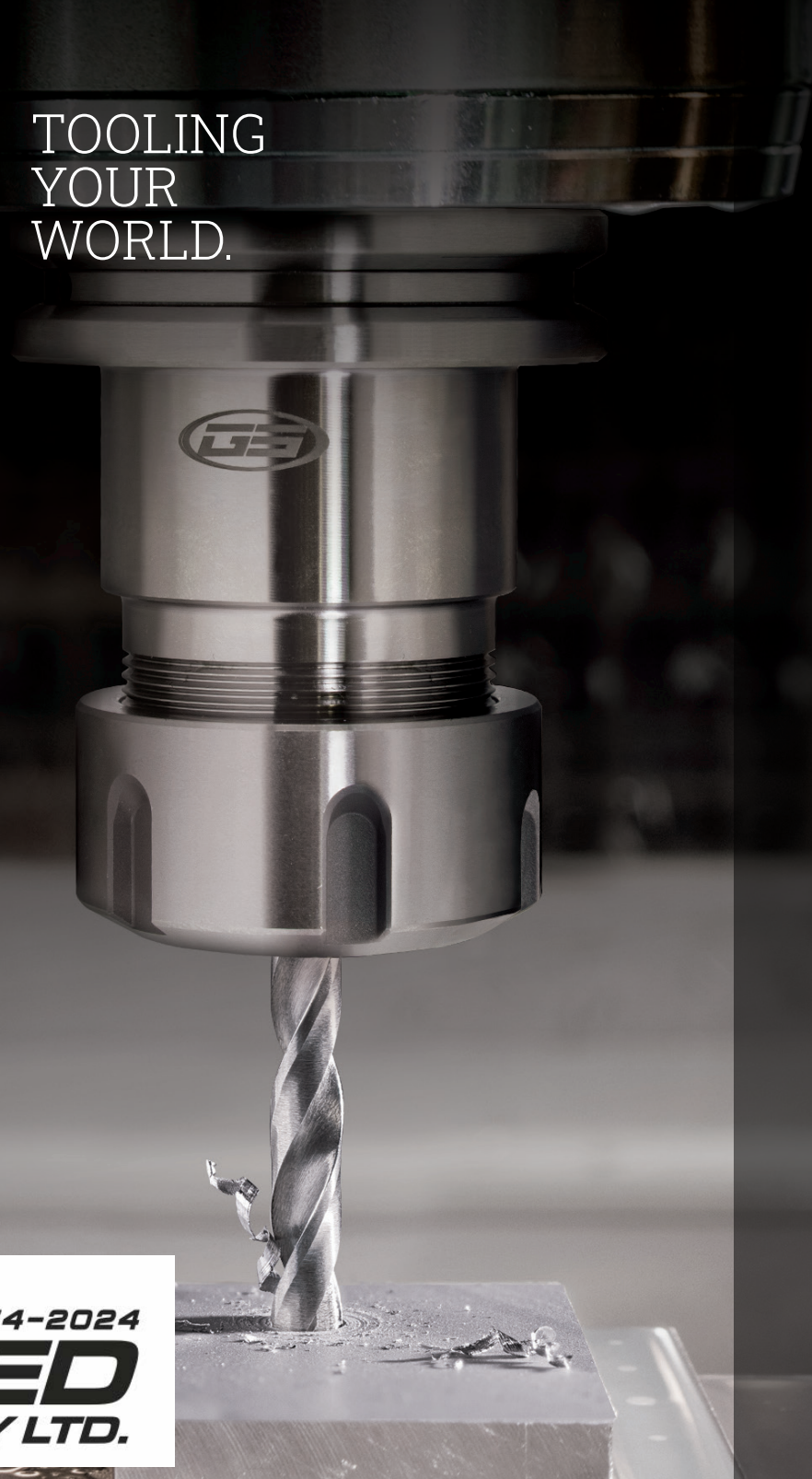

TOOLING
YOUR
WORLD.



Collet Holder Tooling Systems



- ER Collet Systems 4-14
- SA Collet Systems 15
- TG Collet Systems 16-17
- DA Collet Systems 18
- Milling Chuck Systems 19
- Type 25, 32, 5C, R8 & Emergency Collets . 20
- Retention Knobs 21
- Accessories 22



OUR DIFFERENCE IS IN THE DETAILS

Sowa Tool's premium brand, GS Tooling, delivers top-tier quality and performance that rivals or exceeds the best in the world. These products offer exceptional features and dependability, at shockingly affordable prices, making them an ideal choice for applications where accuracy and speed matter most.

There is a reason we say GS stands for "Gold Standard"!



Our STM brand delivers excellent value for your investment. These tools typically apply to less demanding applications where cost has the greatest influence on the selection process.

Artist rendering uses a gold color to clearly show all surfaces that are ground, giving GS Tooling a tighter connectivity and grip in all mated areas.



RETENTION KNOB
Head, neck & pilot

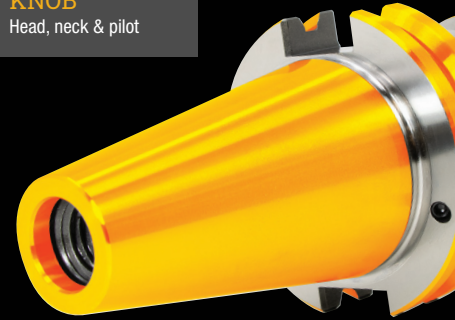

Only the strongest material is used

GS Tooling holders, retention knobs and nuts are all made from **16NiCr4** Premium European Alloy Steel, with a hardness of **58-62 HRC**. This is greater than the industry standard of 48-52 HRC which can distort with use. Our taper accuracy is AT2 or better, for the life of the tool – guaranteed.

Our collets are made from alloy steel with no burrs to damage your tool or decrease accuracy.



Explore our full rotary tooling line at a glance

Sowa Tool offers a large SKU offering of a wide range of rotary tooling: end mill holders, shell mill/face mill holders, shrink fit holders, tap holders, driven tooling and angle heads.

Details	ER Collet Chucks										SA Collet Chucks
Image											
Holder	CAT ER Collet Chuck	CAT ER Collet Chuck	Dual Contact CAT ER Collet Chuck	HSK ER Collet Chuck	ER Collet Chuck Extension	BT ER Collet Chuck	R8 Taper ER Collet Chuck	R8 Taper ER Collet Chuck	NMTB ER Collet Chuck	NMTB ER Collet Chuck	CAT SA High Precision Collet Chuck
Page	Pages 4-5	Pages 4-5	Pages 4-5	Page 5	Page 5	Page 6	Page 6	Page 6	Page 6	Page 6	Page 15
Brand											
Taper	CAT40, 50	CAT40, 50	CAT40, 50	HSK63A, 100A	Extension	BT30, 40, 50	R8	R8	NMTB30	NMTB40, 50	CAT40, 50
Taper Accuracy	AT3 or better	AT2 or better	According to Dual Contact Tolerance	According to DIN69893	h6	AT2 or better	According to R8 Tolerance	According to R8 Tolerance	AT3 or better	AT2 or better	AT2 or better
Coolant Features	AD/B DIN Standard	AD/B DIN Standard	AD/B DIN Standard	Coolant Through	Coolant Through	AD/B JIS Standard	Coolant Through	Coolant Through	Coolant Through	Coolant Through	AD/B DIN Standard
Material Grade	42CrMo	16NiCr4 Premium European Alloy Steel	16NiCr4 Premium European Alloy Steel	16NiCr4 Premium European Alloy Steel	16NiCr4 Premium European Alloy Steel	16NiCr4 Premium European Alloy Steel	SCM415 Steel	16NiCr4 Premium European Alloy Steel	SCM415 Steel	16NiCr4 Premium European Alloy Steel	16NiCr4 Premium European Alloy Steel
Factory Balanced (Certificate Included)	CAT40: G2.5/20,000rpm CAT50: G2.5/15,000rpm	CAT40: G2.5/30,000rpm CAT50: G2.5/25,000rpm	CAT40: G2.5/30,000rpm CAT50: G2.5/25,000rpm	HSK63A: G2.5/30,000rpm HSK100A: G2.5/25,000rpm	Factory Balanced	BT30 & BT40: 2.5/30,000rpm BT50: G2.5/25,000rpm	Factory Balanced	Factory Balanced	Factory Balanced	Factory Balanced	CAT40: 20,000rpm CAT50: 15,000rpm
Runout Accuracy	0.0002"	0.0001"	0.0001"	0.0001"	0.0001"	0.0001"	0.0002"	0.0001"	0.0002"	0.0001"	0.0001"
Thread Tolerance	6h	4h	4h	4h	4h	4h	6h	4h	6h	4h	4h
RFID Chip Hole	Yes	Yes	Yes	Yes	No	Yes	No	No	No	No	Yes

HOLDER

Retention knob seat, taper, v-flange & collet cavity



COLLET

Face, base, I.D. bore & extraction groove



NUT

Outside & eccentric ring

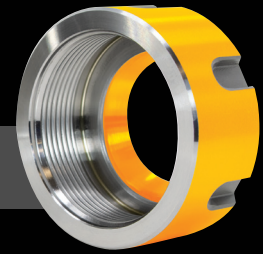

All components are ground to perfection

For an extra level of precision, we start with prebalanced holders and components and invest the time to grind all surfaces that will be in contact with the machine to a fine finish, giving our holder a **runout accuracy of 0.0001"** and **taper and collet cavity have an accuracy of AT2 or better** (Compare this with the runout accuracy of 0.0002" and taper accuracy AT3 of other brands). This offers a tighter connectivity and grip in all mated areas vs turned holders, increasing tolerances throughout.

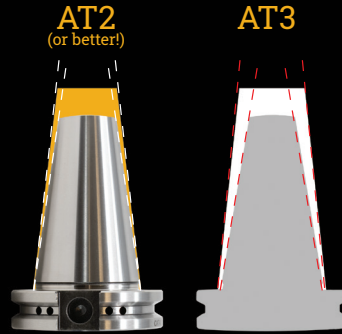

AD/B coolant options are standard

Quality QC

All holders are inspected, one piece at a time. An individualized balance certificate of inspection is included with each holder.

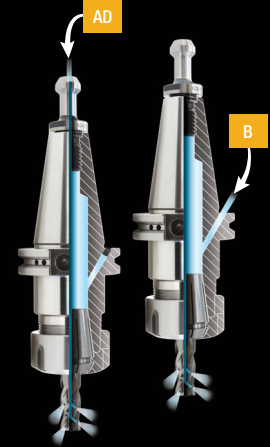

TG Collet Chucks						DA Collet Chucks			Milling Chucks			
CAT TG Collet Chuck	BT TG Collet Chuck	NMTB TG Collet Chuck	R8 TG Collet Chuck	Morse Taper TG Collet Chuck	Straight Shank TG Chuck	CAT DA Collet Chuck	BT DA Collet Chuck	DA Collet Chuck Extension	CAT Milling Chuck	Dual Contact CAT Milling Chuck	BT Milling Chuck	HSK Milling Chuck
Page 16	Page 16	Page 16	Page 16	Page 16	Page 16	Page 18	Page 18	Page 18	Page 19	Page 19	Page 19	Page 19
CAT40, 50	BT30, 40, 50	NMTB40, 50	R8	MT	Straight	CAT40, 50	BT40, 50	Extension	CAT40, 50	CAT40, 50	BT30, 40, 50	HSK63A,100A
AT2 or better	AT2 or better	AT2 or better	According to R8 Tolerance	According to Morse Taper Tolerance	h6	AT2 or better	AT2 or better	h6	AT3 or better	According to Dual Contact Tolerance	AT3 or better	According to DIN69893
AD/B DIN Standard	AD/B JIS Standard	Coolant Through	Coolant Through	Not Coolant Through	Coolant Through	AD/B DIN Standard	AD/B JIS Standard	Coolant Through	AD/B DIN Standard	AD/B DIN Standard	AD/B JIS Standard	Coolant Through
16NiCr4 Premium European Alloy Steel	16NiCr4 Premium European Alloy Steel	16NiCr4 Premium European Alloy Steel	16NiCr4 Premium European Alloy Steel	16NiCr4 Premium European Alloy Steel	16NiCr4 Premium European Alloy Steel	16NiCr4 Premium European Alloy Steel	16NiCr4 Premium European Alloy Steel	16NiCr4 Premium European Alloy Steel	SNCM420	SNCM420	SNCM420	SNCM420
CAT40: 20,000rpm CAT50: 15,000rpm	BT30 & BT40: 20,000rpm BT50: 15,000rpm	Factory Balanced	Factory Balanced	Factory Balanced	Factory Balanced	CAT40: G6.3/30,000rpm CAT50: G6.3/25,000rpm	BT30 & BT40: G6.3/30,000rpm	Factory Balanced	G6.3/10,000rpm	G6.3/10,000rpm	G6.3/10,000rpm	G6.3/10,000rpm
0.0002"	0.0002"	0.0001"	0.0001"	0.0001"	0.0001"	0.0001"	0.0001"	0.0001"	0.00039" @ 3.937"	0.00039" @ 3.937"	0.00039" @ 3.937"	0.00039" @ 3.937"
4h	4h	4h	4h	4h	4h	4h	4h	4h	-	-	-	-
Yes	Yes	No	No	No	No	Yes	Yes	No	Yes	Yes	Yes	Yes



Which holder works best for your application?

STM PREMIUM

The perfect economic tooling solution for general purpose machining applications.

VS

GS TOOLING

Superior tooling performance when speed and accuracy matter most.

42CrMo	Material Grade	16NiCr4 (Premium European Alloy Steel)
AT3 or better (0.00024-0.00036in/ft)	Taper Accuracy	AT2 or better (0.00012-0.00024in/ft)
0.0002"	Runout Accuracy	0.0001"
CAT40 End Mill Holders: Balanced to G2.5 / 8,000rpm CAT50 End Mill Holders: Balanced to G2.5 / 6,000rpm	Balance	CAT40 End Mill Holders: Balanced to G6.3 / 30,000rpm CAT50 End Mill Holders: Balanced to G6.3 / 25,000rpm
CAT40 Collet Chucks: Balanced to G2.5 / 20,000rpm CAT50 Collet Chucks: Balanced to G2.5 / 15,000rpm		CAT40 Collet Chucks: Balanced to G2.5 / 30,000rpm CAT50 Collet Chucks: Balanced to G2.5 / 25,000rpm
AD/B DIN coolant through flange	Coolant Features	AD/B DIN coolant through flange
H6 = basic plus 0.0025-0.0030" (standard class of fit)	Thread Tolerance	H4 = basic plus 0.0015-0.0020" (premium class of fit)
Limited to the most popular items	SKU Offering	Wide selection

CAT40 & CAT50 ER Collet Chucks

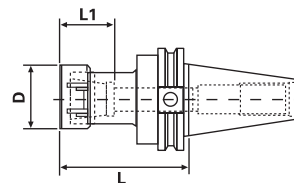

Taper	Collet Series	Collet Range	L	L1	D	Tightening Torque (Nm)	STM Code No.	GS Code No.	GS Dual Contact Code No.
CAT40									
CT40	ER11**	0.019-0.275	2.50	0.65	0.75	29.8	525400	531400	521630
CT40	ER11**	0.019-0.275	4.00	0.65	0.75	29.8	525402	531402	521632
CT40	ER11**	0.019-0.275	6.00	0.65	0.75	29.8	525404	531404	521634
CT40	ER16**	0.019-0.406	2.50	0.87	1.26	56.9	-	531406	521406
CT40	ER16**	0.019-0.413	2.50	0.87	1.26	-	525406	-	-
CT40	ER16**	0.019-0.406	3.50	0.87	1.26	56.9	-	531408	-
CT40	ER16**	0.019-0.413	3.50	0.87	1.26	-	525408	-	-
CT40	ER16**	0.019-0.406	4.00	0.87	1.26	56.9	-	531405	521405
CT40	ER16**	0.019-0.413	4.00	0.87	1.26	-	525405	-	-
CT40	ER16**	0.019-0.406	6.00	0.87	1.26	56.9	-	531410	521405
CT40	ER16**	0.019-0.413	6.00	0.87	1.26	-	525410	-	-
CT40	ER16**	0.019-0.406	9.00	0.87	1.26	56.9	-	531411	-
CT40	ER20**	0.039-0.511	2.50	1.06	1.38	81.3	-	531412	-
CT40	ER20**	0.019-0.551	2.50	1.06	1.38	-	525412	-	-
CT40	ER20**	0.039-0.511	4.00	1.06	1.38	81.3	-	531414	521646



Taper	Collet Series	Collet Range	L	L1	D	Tightening Torque (Nm)	STM Code No.	GS Code No.	GS Dual Contact Code No.
CT40 Cont...									
CT40	ER20**	0.019-0.551	4.00	1.06	1.38	-	525414	-	-
CT40	ER20**	0.039-0.511	6.00	1.06	1.38	81.3	-	531416	-
CT40	ER20**	0.019-0.551	6.00	1.06	1.38	-	525416	-	-
CT40	ER20**	0.039-0.511	9.00	1.06	1.38	81.3	-	531417	-
CT40	ER25	0.039-0.629	2.50	1.18	1.65	128.8	-	531418	-
CT40	ER25	0.059-0.675	2.50	1.18	1.65	-	525418	-	-
CT40	ER25	0.039-0.629	4.00	1.18	1.65	128.8	-	531420	-
CT40	ER25	0.059-0.675	4.00	1.18	1.65	-	525420	-	-
CT40	ER25	0.039-0.629	6.00	1.18	1.65	128.8	-	531422	-
CT40	ER32	0.078-0.787	0.750	-	-	-	-	531401*	-
CT40	ER32	0.078-0.787	2.50	1.34	1.97	169.5	525421	531421	521656
CT40	ER32	0.078-0.787	3.13	1.34	1.97	169.5	525424	531424	521424
CT40	ER32	0.078-0.787	4.00	1.34	1.97	169.5	525423	531423	521423
CT40	ER32	0.078-0.787	5.00	1.34	1.97	169.5	-	531426	-
CT40	ER32	0.078-0.787	6.00	1.34	1.97	169.5	525425	531425	521425
CT40	ER32	0.078-0.787	9.00	1.34	1.97	169.5	-	531419	-
CT40	ER40	0.118-1.023	2.50	1.50	2.48	219.6	-	531427	521666
CT40	ER40	0.118-1.023	3.13	1.50	2.48	219.6	-	531428	-
CT40	ER40	0.118-1.023	4.00	1.50	2.48	219.6	-	531429	-
CT40	ER40	0.118-1.023	5.00	1.50	2.48	219.6	-	531430	-
CT40	ER40	0.118-1.023	6.00	1.50	2.48	219.6	-	531431	-
CAT50									
CT50	ER16**	0.019-0.406	4.12	0.87	1.26	56.9	-	531432	521432
CT50	ER16**	0.019-0.413	4.12	0.87	1.26	-	525432	-	-
CT50	ER16**	0.019-0.406	6.00	0.87	1.26	56.9	-	531434	521434
CT50	ER16**	0.019-0.413	6.00	0.87	1.26	-	525434	-	-
CT50	ER16**	0.019-0.406	8.00	0.87	1.26	56.9	-	531436	521436
CT50	ER16**	0.019-0.406	12.00	0.87	1.26	56.9	-	531437	-
CT50	ER20**	0.039-0.511	2.50	1.06	1.38	81.3	-	531438	-
CT50	ER20**	0.039-0.511	4.00	1.06	1.38	81.3	-	531440	-
CT50	ER20**	0.019-0.551	4.00	1.06	1.38	-	525440	-	-
CT50	ER20**	0.039-0.511	6.00	1.06	1.38	81.3	-	531442	-
CT50	ER20**	0.019-0.551	6.00	1.06	1.38	-	525442	-	-
CT50	ER20**	0.039-0.511	8.00	1.06	1.38	81.3	-	531444	-
CT50	ER20**	0.039-0.511	12.00	1.06	1.38	81.3	-	531445	-
CT50	ER25	0.039-0.629	2.50	1.18	1.65	128.8	-	531446	-
CT50	ER25	0.039-0.629	4.00	1.18	1.65	128.8	-	531448	-
CT50	ER25	0.039-0.629	6.00	1.18	1.65	128.8	-	531450	-
CT50	ER25	0.039-0.629	8.00	1.18	1.65	128.8	-	531452	-
CT50	ER32	0.078-0.787	0.750	-	-	-	-	531403*	-
CT50	ER32	0.078-0.787	4.00	1.34	1.97	169.5	-	531454	521454
CT50	ER32	0.078-0.787	4.00	1.34	1.97	-	525454	-	-
CT50	ER32	0.078-0.787	6.00	1.34	1.97	169.5	-	531456	521456
CT50	ER32	0.078-0.787	6.00	1.34	1.97	-	525456	-	-
CT50	ER32	0.078-0.787	8.00	1.34	1.97	169.5	-	531458	521458
CT50	ER32	0.078-0.787	12.00	1.34	1.97	169.5	-	531459	-
CT50	ER40	0.118-1.023	4.00	1.50	2.48	219.6	-	531460	-
CT50	ER40	0.118-1.023	6.00	1.50	2.48	219.6	-	531462	-
CT50	ER40	0.118-1.023	8.00	1.50	2.48	219.6	-	531464	-

* ER Shorly collet chuck, Not DIN coolant ** Hex Nut. Tightening Torque for GS Tooling only.

HSK ER Collet Chucks

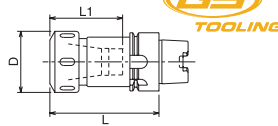

Taper	Collet Series	Collet Range	L	L1	D	Tightening Torque (Nm)	Code No.
HSK63A							
HSK63A	ER16**	0.019-0.393	3.00	0.866	1.260	56.9	536114
HSK63A	ER16**	0.019-0.393	5.00	0.866	1.260	56.9	536116
HSK63A	ER20**	0.039-0.511	3.00	1.062	1.378	81.3	536118
HSK63A	ER20**	0.039-0.511	5.00	1.062	1.378	81.3	536120
HSK63A	ER25	0.039-0.629	3.00	1.181	1.654	128.8	536122
HSK63A	ER25	0.039-0.629	5.00	1.181	1.654	128.8	536124
HSK63A	ER32	0.078-0.787	4.00	1.260	1.969	169.5	536126
HSK63A	ER32	0.078-0.787	6.00	1.260	1.969	169.5	536128
HSK63A	ER40	0.118-1.023	4.00	1.496	2.480	219.6	536130
HSK100A							
HSK100A	ER16**	0.019-0.393	4.00	0.866	1.260	56.9	536134
HSK100A	ER16**	0.019-0.393	6.00	0.866	1.260	56.9	536136
HSK100A	ER20**	0.039-0.511	4.00	1.062	1.378	81.3	536138
HSK100A	ER20**	0.039-0.511	6.00	1.062	1.378	81.3	536140
HSK100A	ER25	0.039-0.629	6.00	1.181	1.654	128.8	536144
HSK100A	ER32	0.078-0.787	4.00	1.260	1.969	169.5	536146
HSK100A	ER32	0.078-0.787	6.00	1.260	1.969	169.5	536148
HSK100A	ER40	0.118-1.023	6.00	1.496	2.480	219.6	536152

** Hex Nut

ER Collet Chuck Extensions

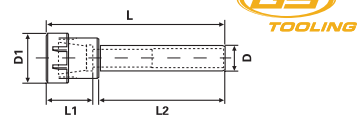

Collet Series	Collet Range	Shank Dia. (D)	D1	L	L1	L2	Tightening Torque (Nm)	Code No.
ER11	0.019-0.275	1/2	0.740	6.11	0.091	5.00	29.8	534368
ER11	0.019-0.275	5/8	0.740	6.11	0.091	5.00	29.8	534370
ER11	0.019-0.275	3/4	0.740	5.65	0.091	5.00	29.8	534372
ER16	0.019-0.406	5/8	1.26	6.48	1.28	5.00	56.9	534374
ER16	0.019-0.406	3/4	1.26	6.48	1.28	5.00	56.9	534376
ER16	0.019-0.406	1	1.26	5.89	1.28	5.00	56.9	534378
ER20	0.039-0.511	3/4	1.38	6.67	1.48	5.00	81.3	534380
ER20	0.039-0.511	1	1.38	6.40	1.48	5.00	81.3	534382
ER20	0.039-0.511	1-1/4	1.38	6.40	1.48	5.00	81.3	534384
ER25	0.039-0.629	3/4	1.65	6.85	1.65	5.00	128.8	534386
ER25	0.039-0.629	1	1.65	6.85	1.65	5.00	128.8	534388
ER25	0.039-0.629	1-1/4	1.65	6.00	1.65	5.00	128.8	534390
ER32	0.078-0.787	1	1.97	7.09	1.85	5.00	169.5	534392
ER32	0.078-0.787	1-1/4	1.97	6.30	2.13	4.00	169.5	337805
ER32	0.078-0.787	1-1/4	1.97	7.09	1.85	5.00	169.5	534394

BT Taper ER Collet Chucks

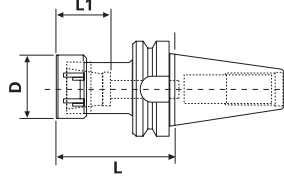

Taper	Collet Series	Collet Range	L	L1	D	Tightening Torque (Nm)	Code No.
BT30							
BT30	ER11**	0.019-0.275	2.00	0.65	0.75	29.8	532150*
BT30	ER11**	0.019-0.275	4.00	0.65	0.75	29.8	532152*
BT30	ER16**	0.019-0.406	2.36	0.87	1.26	56.9	532154*
BT30	ER16**	0.019-0.406	4.00	0.87	1.26	56.9	532156*
BT30	ER16**	0.019-0.406	5.00	0.87	1.26	56.9	532158*
BT30	ER16**	0.019-0.406	6.00	0.87	1.26	56.9	532160*
BT30	ER20**	0.039-0.511	2.50	1.06	1.38	81.3	532162*
BT30	ER20**	0.039-0.511	4.00	1.06	1.38	81.3	532164*
BT30	ER25	0.039-0.629	2.00	1.18	1.65	128.8	532166*
BT30	ER25	0.039-0.629	4.00	1.18	1.65	128.8	532168*
BT30	ER32	0.078-0.787	3.00	1.34	1.97	169.5	532170*
BT30	ER32	0.078-0.787	5.00	1.34	1.97	169.5	532172*
BT40							
BT40	ER11**	0.019-0.275	4.00	0.65	0.75	29.8	532176
BT40	ER11**	0.019-0.275	6.00	0.65	0.75	29.8	532178
BT40	ER16**	0.019-0.406	3.50	0.87	1.26	56.9	532180
BT40	ER16**	0.019-0.406	5.00	0.87	1.26	56.9	532182
BT40	ER20**	0.039-0.511	2.50	1.06	1.38	81.3	532184
BT40	ER20**	0.039-0.511	4.00	1.06	1.38	81.3	532186
BT40	ER20**	0.039-0.511	6.00	1.06	1.38	81.3	532188
BT40	ER25	0.039-0.629	2.25	1.18	1.65	128.8	532190
BT40	ER25	0.039-0.629	4.00	1.18	1.65	128.8	532192
BT40	ER25	0.039-0.629	6.00	1.18	1.65	128.8	532194
BT40	ER32	0.078-0.787	1.06	-	-	-	532191*
BT40	ER32	0.078-0.787	3.13	1.34	1.97	169.5	532196
BT40	ER32	0.078-0.787	5.00	1.34	1.97	169.5	532198
BT40	ER40	0.118-1.023	3.13	1.50	2.50	219.6	532200
BT40	ER40	0.118-1.023	5.00	1.50	2.50	219.6	532202
BT50							
BT50	ER16**	0.019-0.406	2.50	0.87	1.26	56.9	532203
BT50	ER25	0.039-0.629	4.00	1.18	1.65	128.8	532206

* Not DIN Coolant ** Hex Nut + ER Shorty Collet Chuck

NMTB Taper ER Collet Chucks

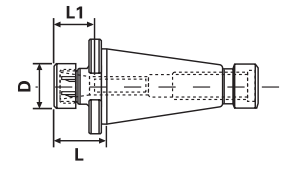

Taper	Collet Series	Collet Range	L	L1	D	Tightening Torque (Nm)	STM Code No.	GS Code No.
NMTB30								
NMTB30	ER32	-	2.17	-	1.96	-	337825	-
NMTB30	ER40	-	3.35	-	2.48	-	337830	-
NMTB40	ER40	-	2.16	-	2.48	-	337835	-
NMTB50	ER40	-	2.28	-	2.48	-	337840	-
NMTB40								
NMTB40	ER16	0.019-0.406	1.77	0.87	1.26	56.9	-	534352
NMTB40	ER25	0.039-0.629	2.00	1.18	1.65	128.8	-	534354
NMTB40	ER32	0.078-0.787	2.00	-	-	-	-	534260
NMTB50								
NMTB50	ER16	0.019-0.406	2.00	0.87	1.26	56.6	-	534356

R8 Taper ER Collet Chucks

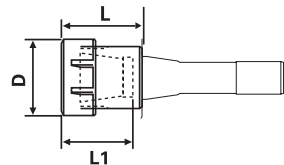

Taper	Collet Series	Collet Range	L	L1	D	Tightening Torque (Nm)	STM Code No.	GS Code No.
R8	ER16	0.019-0.406	1.25	1.138	1.25	56.9	-	534360
R8	ER20	0.039-0.511	2.00	1.50	1.38	81.3	-	534362
R8	ER25	0.039-0.629	2.50	1.64	1.66	128.8	-	534364
R8	ER32	0.078-0.787	1.58	-	1.97	-	337815	-
R8	ER40	0.118-1.023	2.75	-	2.48	-	337820	-

ER Replacement Parts



Part	Series	Description	Code No.
Replacement Backup Screws			
	ER11	Steam Oxide Nut (Hex)	534814
	ER16	Balanced & Bright Nut (Hex)	534816
	ER20	Steam Oxide Nut (Hex)	534818
	ER25	Balanced & Bright Nut (Hex)	534820
	ER32	Steam Oxide Nut (Hex)	534822
	ER40	Balanced & Bright Nut (Hex)	534824
Replacement Collet Chuck Nuts			
	ER11	Steam Oxide Coated Nut (Hex)	337680
	ER11	Balanced & Bright Nut (Hex)	534790
	ER16	Steam Oxide Coated Nut (Hex)	337389
	ER16	Balanced & Bright Nut (Hex)	534792
	ER20	Steam Oxide Coated Nut (Hex)	337391
	ER20	Balanced & Bright Nut (Hex)	534794
	ER25	Steam Oxide Coated Nut (Notched)	337390
	ER25	Balanced & Bright Nut (Notched)	534796
	ER32	Steam Oxide Coated Nut (Notched)	337392
	ER32	Balanced & Bright Nut (Notched)	534798
	ER40	Steam Oxide Coated Nut (Notched)	337393
	ER40	Balanced & Bright Nut (Notched)	534800
	ER50	Steam Oxide Coated Nut (Notched)	337385
	ER32	Balanced & Bright Nut for Shorty Chucks (M40 x 1.5 Thread)	337411
Collet Chuck Nut Wrenches			
	ER11	Chuck Wrench (Hex)	337388
	ER16	Chuck Wrench (Hex)	337395
	ER20	Chuck Wrench (Hex)	337397
	ER25	Chuck Wrench (Notched)	337396
	ER32	Chuck Wrench (Notched)	337398
	ER40	Chuck Wrench (Notched)	337399
	ER32	Shorty Chuck Wrench	337381

**Sowa has
your tooling
needs covered.**

- Retention Knobs
- Tool Holding
- Collets
- Cutting Tools
- Measuring & Inspecting
- Workholding
- Accessories
and more!

www.SowaTool.ca



ER Collet Sets

* Cases may not be as shown



ER Standard Collet Sets

Series	Description	Collet Range	Code No.
Inch			
ER11	Inch 7pc Standard Collet Set	1/16-1/4 x 1/32	337401
ER16	Inch 11pc Standard Collet Set	1/16-3/8 x 1/32	337403
ER20	Inch 15pc Standard Collet Set	1/16-1/2 x 1/32	337404
ER25	Inch 17pc Standard Collet Set	1/8-5/8 x 1/32	337405
ER32	Inch 21pc Standard Collet Set	1/8-3/4 x 1/32	337407
ER40	Inch 29pc Standard Collet Set	1/8-1 x 1/32	337409
Metric			
ER11	Metric 13pc Standard Collet Set	1-7mm x 0.5mm	337379
ER16	Metric 10pc Standard Collet Set	1-10mm x 1mm	337380
ER20	Metric 12pc Standard Collet Set	2-13mm x 1mm	337382
ER25	Metric 15pc Standard Collet Set	2-16mm x 1mm	337383
ER32	Metric 18pc Standard Collet Set	3-20mm x 1mm	337384
ER40	Metric 23pc Standard Collet Set	3.5-26mm x 1mm	337386
ER50	Metric 11pc Standard Collet Set	12-32mm x 2mm	337387

ER 5 Micron AA ER Standard Collet Sets

Series	Description	Collet Range	Code No.
Inch			
ER11	Inch 7pc Collet Set	1/16-1/4 x 1/32	336992
ER16	Inch 11pc Collet Set	1/16-3/8 x 1/32	336993
ER20	Inch 15pc Collet Set	1/16-1/2 x 1/32	336994
ER25	Inch 18pc Collet Set	3/32-5/8 x 1/32	336995
ER32	Inch 21pc Collet Set	1/8-3/4 x 1/32	336996
ER40	Inch 15pc Collet Set	1/8-1 x 1/16	336997
Metric			
ER11	Metric 13pc Collet Set	1-7mm x 0.5mm	336986
ER16	Metric 10pc Collet Set	1-10mm x 1.0mm	336987
ER20	Metric 12pc Collet Set	2-13mm x 1.0mm	336988
ER25	Metric 15pc Collet Set	2-16mm x 1.0mm	336989
ER32	Metric 18pc Collet Set	3-20mm x 1.0mm	336990
ER40	Metric 23pc Collet Set	4-26mm x 1.0mm	336991

ER Sealed Collet Sets

Series	Description	Collet Range	Code No.
Inch			
ER11	Inch 6pc Sealed Collet Set	3/16-17/64 x 1/64	337929
ER16	Inch 10pc Sealed Collet Set	1/8-13/32 x 1/32	337931
ER20	Inch 12pc Sealed Collet Set	5/32-1/2 x 1/32	337933
ER25	Inch 13pc Sealed Collet Set	1/4-5/8 x 1/32	337938
ER32	Inch 17pc Sealed Collet Set	1/4-3/4 x 1/32	337940
Metric			
ER16	Metric 13pc Sealed Collet Set	4-10mm x 0.5mm	337932
ER20	Metric 17pc Sealed Collet Set	5-13mm x 0.5mm	337935
ER25	Metric 21pc Sealed Collet Set	6-16mm x 0.5mm	337939
ER32	Metric 20pc Sealed Collet Set	10.5-20mm x 0.5mm	337942
ER40	Metric 33pc Sealed Collet Set	10-26mm x 0.5mm	337944

Collet Holder Tooling Systems

ER Collet & Collet Chuck Sets

Our ER collet system is made of a special alloy steel material under intense heat treatment with a precise grinding process, so it has accuracy, powerful clamping ability, and durability. This collet can clamp for a specific standard size and its next size.

It can be widely used for boring, milling, drilling and tapping as well as for grinding operation, and is available for all sizes.



Set shown: 337345

Shank	Description	Collet Range	Code No.
ER16			
3/4 x 4	10pc Collet Set Included	0.019 - 0.393	337700
3/4 x 6	10pc Collet Set Included	0.019 - 0.393	337705
R8	10pc Collet Set Included	0.019 - 0.393	337710
ER20			
3/4 x 4	12pc Collet Set Included	0.039 - 0.511	337715
3/4 x 6	12pc Collet Set Included	0.039 - 0.511	337720
ER32			
1-1/4 x 4	11pc Collet Set Included	0.080 - 0.787	337730
ISO-30	11pc Collet Set Included	0.080 - 0.787	337735
R8	11pc Collet Set Included	0.080 - 0.787	337740
ER40			
R8	15pc Collet Set Included	0.120 - 1.020	337745
ISO-30	15pc Collet Set Included	0.120 - 1.020	337750
ISO-40	15pc Collet Set Included	0.120 - 1.020	337755
ISO-50	23pc Collet Set Included	0.120 - 1.020	337760

ER Tap Collet Sets

For synchronous, rigid tapping operations using ER collet chucks.

Collet bore is exact tool diameter with square drive for accuracy and rigidity.



Set shown: 337345

Series	Description	Collet Range	Code No.
Inch			
ER16	Inch 5pc Tap Collet Set	#6 - 1/4	337986
ER16	Inch 9pc Tap Collet Set	#6 - 1/2	337343
ER20	Inch 9pc Tap Collet Set	#6 - 1/2	337345
ER32	Inch 16pc Tap Collet Set	#6 - 13/16	337351
ER40	Inch 21pc Tap Collet Set	#6 - 1	337353
Metric			
ER32	Metric 11pc Tap Collet Set	M4 - M26	337992

DA Collet Sets



Set shown: 331362

Series	Description	Collet Range	Code No.
DA100	Inch 8pc Collet Set	1/8-9/16 x 1/16	331356
DA100	Inch 11pc Collet Set	1/4-9/16 x 1/32	331358
DA100	Inch 15pc Collet Set	1/8-9/16 x 32	331362
DA100	Inch 17pc Collet Set	1/16-9/16 x 32	331384
DA100	Inch 21pc Collet Set	1/4-9/16 x 64	331385
DA100	Inch 29pc Collet Set	1/8-9/16 x 64	331386
DA100	Inch 33pc Collet Set	1/16-9/16 x 64	331387
DA180	Inch 9pc Collet Set	1/4-3/4 x 16	331388
DA180	Inch 17pc Collet Set	1/4-3/4 x 32	331389
DA180	Inch 21pc Collet Set	1/8-3/4 x 32	331390
DA180	Inch 33pc Collet Set	1/4-3/4 x 64	331391
DA180	Inch 41pc Collet Set	1/8-3/4 x 64	331392
DA200	Inch 9pc Collet Set	1/8-3/8 x 32	331393
DA200	Inch 11pc Collet Set	1/16-3/8 x 32	331394
DA200	Inch 17pc Collet Set	1/8-3/8 x 64	331395
DA200	Inch 21pc Collet Set	1/16-3/8 x 64	331396
DA300	Inch 7pc Collet Set	1/16-1/4 x 32	331397
DA300	Inch 13pc Collet Set	1/16-1/4 x 64	331399
DA300	Inch 14pc Collet Set	3/64-1/4 x 64	331400

Standard TG Collet Sets



Set shown: 334561

Series	Description	Collet Range	Code No.
TG75	Inch 43pc Collet Set	3/32-3/4 x 1/64	334900
TG75	Inch 41pc Collet Set	1/8-3/4 x 1/64	334901
TG75	Inch 33pc Collet Set	1/4-3/4 x 1/64	334902
TG75	Inch 25pc Collet Set	3/8-3/4 x 1/64	334903
TG75	Inch 22pc Collet Set	3/32-3/4 x 1/32	334904
TG75	Inch 13pc Collet Set	3/8-3/4 x 1/32	334905
TG75	Inch 11pc Collet Set	1/8-3/4 x 1/16	334906
TG100	Inch 59pc Collet Set	3/32-1 x 1/64	334575
TG100	Inch 41pc Collet Set	3/8-1 x 1/64	334570
TG100	Inch 30pc Collet Set	3/32-1 x 1/32	334565
TG100	Inch 21pc Collet Set	3/8-1 x 1/32	334560
TG100	Inch 15pc Collet Set	1/8-1 x 1/16	334561
TG150	Inch 33pc Collet Set	1/2-1-1/2 x 1/32	334585

Type 25 & Type 32 Collet Chuck Sets

Set includes:

1 chuck, 1 wrench, 1 each collet and fitted case



Set shown: 334605

Shank	Description	Collet Range	Code No.
TYPE 25			
ISA-30	Inch 10pc Collet Set Included	1/8 - 1	334600
ISA-40	Inch 10pc Collet Set Included	1/8 - 1	334605
ISA-50	Inch 10pc Collet Set Included	1/8 - 1	334608
M.T.3	Inch 10pc Collet Set Included	1/8 - 1	334610
M.T.4	Inch 10pc Collet Set Included	1/8 - 1	334615
R8	Inch 10pc Collet Set Included	1/8 - 1	334620
TYPE 32			
ISA-40	Inch 15pc Collet Set Included	1/4 - 1-1/4	334625
ISA-50	Inch 15pc Collet Set Included	1/4 - 1-1/4	334630
M.T.5	Inch 15pc Collet Set Included	1/4 - 1-1/4	334635

Component Parts For 1" Type 25 Sets & 1-1/4" Type 32 Sets

Series Type	Description	Code No.
1 (Type 25)	Wrench	334650
1 (Type 25)	Nuts	334645
1 (Type 25)	Fitted Case	334640
1 (Type 25)	Chuck ISA-30	334655
1 (Type 25)	Chuck ISA-40	334660
1 (Type 25)	Chuck ISA-50	334663
1 (Type 25)	Chuck MT 3	334665
1 (Type 25)	Chuck MT 4	334670
1 (Type 25)	Chuck R8	334675
1-1/4 (Type 32)	Wrench	334690
1-1/4 (Type 32)	Nuts	334685
1-1/4 (Type 32)	Fitted Case	334680
1-1/4 (Type 32)	Chuck ISA-40	334695
1-1/4 (Type 32)	Chuck ISA-50	334700
1-1/4 (Type 32)	Chuck MT 5	334705

Collet Rack

Holds 5C, C32, or Type 25 collets
220 x 110 x 6mm
Plastic



* Collets not included

Model	Code No.
VMS-5	325305

ER Collets

Our ER collet system is made of special alloy steel material under excellent heat treatment and precise grinding process, so it is durable with precise accuracy and has a powerful clamping ability. This collet can clamp for a specific standard size and its next size. It can be widely used for boring, milling, drilling and tapping as well as for grinding operation, and is available for all sizes.

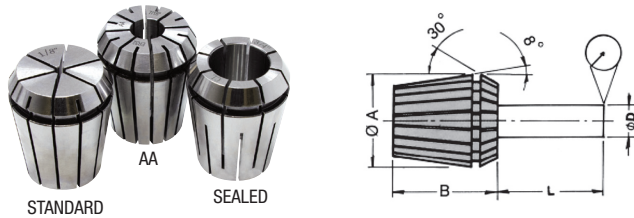

ER Spring Collet Dimensional Data

Type	A (mm)	B (mm)	L (mm)	ØD (mm)	DIN 6343 Precision	GS Precision
ER11	11.5	18	-	-	0.02	0.010
ER16	17	27	6	1.0-1.4	0.02	0.010
ER20	21	31	10	1.5-2.9	0.02	0.010
ER25	26	35	16	3.0-5.9	0.02	0.010
ER32	33	40	25	6.0-9.9	0.02	0.010
ER40	41	46	40	10.0-17.9	0.03	0.010
ER50	52	60	50	18.0-26.9	0.03	0.010

Mounting Instructions for ER Collets

Place collet inside nut and rotate the nut to engage with the extractor spiral in collet groove. Only then mount nut and collet together into the collet holder or machine spindle.

Note: Never use a 12-11mm collet to clamp a 12mm diameter, but rather use a 13-12mm collet.

ER8 Collets

Size	Collet Range	Standard Code No.	AA Code No.	Sealed Code No.
ER8 Inch				
1/16	-	337629	-	-
1/8	-	337631	-	-
3/16	-	337625	-	-
ER8 Metric				
0.5-1.0	0.019-0.039	337635	-	-
1.0-1.5	0.039-0.059	337637	-	-
2.0-2.5	0.078-0.098	337641	-	-
2.5-3.0	0.098-0.118	337643	-	-
3.0-3.5	0.118-0.137	337645	-	-
3.5-4.0	0.137-0.157	337647	-	-
4.0-4.5	0.157-0.177	337648	-	-
4.5-5.0	0.177-0.196	337649	-	-

ER11 Collets

Size	Collet Range	Standard Code No.	AA Code No.	Sealed Code No.
ER11 Inch				
3/64	-	337609	336701	-
1/16	0.0394-0.0790	337610*	336703*	-
5/64	-	337611	336704	-
3/32	0.0787-0.1180	337613*	336706*	-
7/64	-	337614	336708	-
1/8	0.1181-0.1570	337615*	336710*	-
9/64	-	337617	336712	-
5/32	-	337618*	336713*	-
11/64	-	337619	336715	-
3/16	0.1575-0.1970	337651*	336717*	337622
13/64	-	337653	336719	337624
7/32	0.1969-0.2360	337655*	336721*	337626
15/64	-	337657	336722	337628
1/4	0.2362-0.2760	337659*	336724*	337630
17/64	-	337661	336726	337632
9/32	-	337627	336728	-
7pc Set	1/16-1/4	337401	336992	-

Extreme Precision 5 Micron Collets

DIN 6343 Precision Collets have a runout of 20-30 microns (0.02 - 0.03mm)

GS High Precision Collets have a runout of 10-20 microns (0.01 - 0.02mm)

The new **GS Extreme Precision AA Collets** have a runout of only 5 microns (0.005mm)

- 16 slots allows sufficient collapse while increasing the area of contact with less tendency to distort
- All edges are deburred and rounded to promote good interface with the taper of the chuck without the tendency to damage it. This results in more consistent repeatability
- Collets are polished to eliminate blemishes that promote corrosion. Better corrosion resistance will result in longer product life of both the collet and the holder between the collet and the cutting tool shank
- Minimized variation of cutting edges
- Maximized concentricity
- Evenly distributed cutting edges for high performance machining
- Highly polished OD surfaces reduce the amount of force absorbed by friction between the collet and the collet chuck seat, increasing the grip force of the cutting tool. The inside bore of the collet is intentionally left unpolished to increase the friction
- Improve system performance and lower cost per piece when used with quality GS chucks
- Consistent cutting profiles ensure the job stays within desired tolerances

5 Micron AA ER Collet Run-Out Tolerance Values

Nominal Diameter		l12	Run-Out Tolerance A	
Above	Up To (included)		Class 1	Class 2
1 (included)	1.6	6	0.005	0.015
1.6	3	10		
3	6	16		
6	10	25		
10	18	40	0.005	0.020
18	26	50		

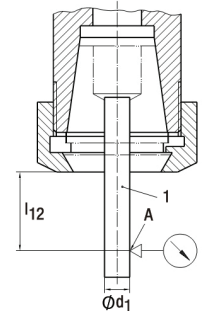

ER11 Metric

0.5-1	0.019-0.039	337650*	336700*	-
1-1.5	0.039-0.059	337652*	336702*	-
1.5-2	0.059-0.078	337654*	336705*	-
2-2.5	0.078-0.098	337656*	336707*	-
2.5-3	0.098-0.118	337658*	336709*	-
3-3.5	0.118-0.137	337660*	336711*	-
3.5-4	0.137-0.157	337662*	336714*	-
4-4.5	0.157-0.177	337664*	336716*	-
4.5	-	-	-	337636
4.5-5	0.177-0.196	337666*	336718*	-
5-5.5	0.196-0.216	337668*	336720*	-
5.5	-	-	-	337640
5.5-6	0.216-0.236	337670*	336723*	-
6	-	-	-	337642
6-6.5	0.236-0.255	337672*	336725*	-
6.5	-	-	-	337644
6.5-7	0.255-0.275	337674*	336727*	-
7	-	-	-	337646
13pc Set	1-7mm	337379	336986	-

* Part of Set

ER16 Collets

Size	Collet Range	Standard Code No.	AA Code No.	Sealed Code No.
ER16 Inch				
1/16	0.0394-0.0790	337531*	336731*	-
3/32	0.0787-0.1180	337532*	336733*	-
1/8	0.1181-0.1570	337533*	336736*	337841*
9/64	-	337529	336738	-
5/32	-	337534*	336739*	337842*
3/16	0.1575-0.1970	337535*	336742*	337843*
13/64	-	-	-	337826
7/32	0.1969-0.2360	337536*	336745*	337844*
15/64	-	-	-	337827
1/4	0.2362-0.2760	337537*	336747*	337845*
17/64	-	-	-	337828
9/32	-	337538*	336750*	337846*
19/64	-	-	-	337829
5/16	0.2756-0.3150	337540*	336752*	337847*
21/64	-	-	-	337831

Collet Holder Tooling Systems

Size	Collet Range	Standard Code No.	AA Code No.	Sealed Code No.
<i>ER16 Inch Cont...</i>				
11/32	0.3150-0.3540	337541*	336755*	337848*
23/64	-	-	-	337832
3/8	0.3543-0.3940	337542*	336758*	337849*
25/64	-	-	-	337833
13/32	-	337543	336760	337834*
10pc Set	1/8-13/32	-	-	337931
11pc Set	1/16-3/8	337403	336993	-
ER16 Metric				
0.5-1	0.019-0.039	337302*	336729*	-
1-1.5	0.039-0.059	-	336730	-
1-2	0.039-0.078	337304*	-	-
1.5-2	0.059-0.078	-	336732*	-
2-2.5	0.078-0.098	-	336734	-
2-3	0.078-0.118	337306*	-	-
2.5-3	0.098-0.118	-	336735*	-
3	-	-	-	338290
3-3.5	0.118-0.137	-	336737	-
3.5	-	-	-	338291
3-4	0.118-0.157	337308*	-	-
3.5-4	0.137-0.157	-	336740*	-
4	-	-	-	338292*
4-4.5	0.157-0.177	-	336741	-
4.5	-	-	-	338294*
4-5	0.157-0.196	337310*	-	-
4.5-5	0.177-0.196	-	336743*	-
5	-	-	-	338296*
5-5.5	0.196-0.217	-	336744	-
5.5	-	-	-	338298*
5-6	0.196-0.236	337312*	-	-
5.5-6	0.217-0.236	-	336746*	-
6-6.5	0.236-0.256	-	336748	-
6	-	-	-	338300*
6-7	0.236-0.275	337314*	-	-
6.5	-	-	-	338302*
6.5-7	0.256-0.275	-	336749*	-
7	-	-	-	338304*
7-7.5	0.275-0.295	-	336751	-
7.5	-	-	-	338305*
7-8	0.275-0.314	337316*	-	-
7.5-8	0.295-0.314	-	336753*	-
8	-	-	-	338306*
8-8.5	0.314-0.335	-	336754	-
8.5	-	-	-	338307*
8-9	0.314-0.354	337318*	-	-
8.5-9	0.335-0.354	-	336756*	-
9	-	-	-	338308*
9-9.5	0.354-0.374	-	336757	-
9.5	-	-	-	338309*
9-10	0.354-0.393	337320*	-	-
9.5-10	0.374-0.393	-	336759*	-
10	-	-	-	338310*
10pc Set	1-10mm	337380	336987	-
13pc Set	4-10mm	-	-	337932

* Part of Set

ER20 Collets

Size	Collet Range	Standard Code No.	AA Code No.	Sealed Code No.
ER20 Inch				
1/16	0.0394-0.0790	337621*	336762*	-
3/32	0.0787-0.1180	337623*	336764*	-
1/8	0.1181-0.1570	337663*	336767*	337856**
5/32	-	337665*	336769*	337857
3/16	0.1575-0.1970	337667*	336772*	337858
7/32	0.1969-0.2360	337669*	336775*	337859
1/4	0.2362-0.2760	337671*	336777*	337860
9/32	-	337673*	336780*	337861
5/16	0.2756-0.3150	337675*	336782*	337862
11/32	0.3150-0.3540	337676*	336785*	337863
3/8	0.3543-0.3940	337677*	336788*	337864
13/32	0.3937-0.4330	337678*	336790*	337865
7/16	0.4331-0.4720	337679*	336793*	337866
15/32	-	337681*	336795*	337867

Size	Collet Range	Standard Code No.	AA Code No.	Sealed Code No.
<i>ER20 Inch Cont...</i>				
1/2	0.4724-0.5120	337682*	336798*	337868
12pc Set	5/32-1/2	-	-	337933
15pc Set	1/16-1/2	337404	336994	-
ER20 Metric				
1-1.5	0.039-0.059	337446	-	-
1.5-2	0.059-0.078	-	336763*	-
1-2	0.039-0.078	337473*	-	-
2-2.5	0.078-0.098	337447	336765	-
2-3	0.078-0.118	337474*	-	-
2.5-3	0.098-0.118	-	336766*	-
2.5-3.5	0.098-0.137	337471	-	-
3-3.5	0.118-0.137	-	336768	-
3-4	0.118-0.157	337475*	-	-
3.5-4	0.137-0.157	-	336770*	-
4	-	-	-	338325**
4-4.5	0.157-0.177	337448	336771	-
4.5	-	-	-	338299**
4-5	0.157-0.196	337476*	-	-
4.5-5	0.177-0.196	-	336773*	-
5	-	-	-	338330
5-5.5	0.196-0.217	337449	336774	-
5.5	-	-	-	338334
5-6	0.196-0.236	337477*	-	-
5.5-6	0.217-0.236	-	336776*	-
6	-	-	-	338336
6-6.5	0.236-0.256	337451	336778	-
6.5	-	-	-	338337
6-7	0.236-0.275	337478*	-	-
6.5-7	0.256-0.275	-	336779*	-
7	-	-	-	338338
7-7.5	0.275-0.295	337453	336781	-
7.5	-	-	-	338339
7-8	0.275-0.314	337479*	-	-
7.5-8	0.295-0.314	-	336783*	-
8	-	-	-	338340
8-8.5	0.314-0.335	337455	336784	-
8.5	-	-	-	338341
8-9	0.314-0.354	337480*	-	-
8.5-9	0.335-0.354	-	336786*	-
9	-	-	-	338342
9-9.5	0.354-0.374	337457	336787	-
9.5	-	-	-	338343
9-10	0.354-0.393	337481*	-	-
9.5-10	0.374-0.393	-	336789*	-
10	-	-	-	338344
10-10.5	0.393-0.413	337459	336791	-
10.5	-	-	-	338345
10-11	0.393-0.433	337482*	-	-
10.5-11	0.413-0.433	-	336792*	-
11	-	-	-	338346
11-11.5	0.433-0.452	337469	336794	-
11.5	-	-	-	338347
11-12	0.433-0.472	337483*	-	-
11.5-12	0.452-0.472	-	336796*	-
12	-	-	-	338348
12-12.5	0.472-0.492	337463	336797	-
12.5	-	-	-	338349
12-13	0.472-0.511	337484*	-	-
12.5-13	0.492-0.511	-	336799*	-
13	-	-	-	338350
13-13.5	0.511-0.531	-	336800	-
13.5-14	0.531-0.551	-	336801	-
12pc Set	2-13mm	337382	336988	-
17pc Set	5-13mm	-	-	337935

* Part of set ** Not Part of Set

ER25 Collets

Size	Collet Range	Standard Code No.	AA Code No.	Sealed Code No.
ER25 Inch				
3/32	0.0787-0.1180	337602**	336803*	-
1/8	0.1181-0.1570	337683	336806*	337878

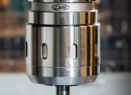

Size	Collet Range	Standard Code No.	AA Code No.	Sealed Code No.
ER25 Inch Cont...				
5/32	-	337684	336808*	337879
3/16	0.1575-0.1970	337685	336811*	337880
7/32	0.1969-0.2360	337686	336814*	337881
1/4	0.2362-0.2760	337687	336817*	337882*
17/64	0.4331-0.4720	-	-	338352
9/32	-	337688	336819*	337883*
19/64	-	-	-	338354
5/16	0.2756-0.3150	337689	336821*	337884*
21/64	-	-	-	338356
11/32	0.3150-0.3540	337691	336824*	337885*
23/64	-	-	-	338358
3/8	0.3543-0.3940	337692	336827*	337886*
25/64	-	-	-	337916
13/32	0.3937-0.4330	337693	336829*	337887*
27/64	-	-	-	337917
7/16	0.4331-0.472	337694	336832*	337888*
29/64	-	-	-	337918
15/32	-	337696	336834*	337889*
31/64	-	-	-	337919
1/2	0.4724-0.5120	337697	336837*	337890*
33/64	-	-	-	337920
17/32	0.5118-0.5510	337698	336839*	337891*
35/64	-	-	-	337921
9/16	0.5512-0.5910	337699	336842*	337892*
37/64	-	-	-	337922
19/32	-	337701	336845*	337893*
39/64	-	-	-	337923
5/8	0.5906-0.6300	337702	336847*	337894*
17pc Set	1/8-5/8	337405	-	-
18pc Set	3/32-5/8	-	336995	-
13pc Set	1/4-5/8	-	-	337938
ER25 Metric				
1-2	0.039-0.078	337330*	-	-
1.5-2	0.059-0.078	-	336802*	-
2-2.5	0.078-0.098	337274	336804	-
2-3	0.078-0.118	337332*	-	-
3	-	-	-	338297
2.5-3	0.098-0.118	-	336805*	-
2.5-3.5	0.098-0.137	337333	-	-
3.5	-	-	-	338326
3-3.5	0.118-0.137	-	336807	-
3-4	0.118-0.157	337334*	-	-
4	-	-	-	338327
3.5-4	0.137-0.157	-	336809*	-
4-4.5	0.157-0.177	337486	336810	-
4.5	-	-	-	338373
4-5	0.157-0.196	337336*	-	-
5	-	-	-	338329
4.5-5	0.177-0.196	-	336812*	-
5-5.5	0.196-0.217	337487	336813	-
5.5	-	-	-	338331
5-6	0.196-0.236	337338*	-	-
6	-	-	-	338360*
5.5-6	0.217-0.236	-	336815*	-
6-6.5	0.236-0.256	337488	336816	-
6.5	-	-	-	338362*
6-7	0.236-0.275	337340*	-	-
7	-	-	-	338364*
6.5-7	0.256-0.275	-	336818*	-
7-7.5	0.275-0.295	337489	336820	-
7.5	-	-	-	338366*
7-8	0.275-0.314	337342*	-	-
8	-	-	-	338368*
7.5-8	0.295-0.314	-	336822*	-
8-8.5	0.314-0.335	337490	336823	-
8.5	-	-	-	338370*
8-9	0.314-0.354	337344*	-	-
9	-	-	-	338372*
8.5-9	0.335-0.354	-	336825*	-
9-9.5	0.354-0.374	337491	336826	-
9.5	-	-	-	338374*
9-10	0.354-0.393	337346*	-	-

Size	Collet Range	Standard Code No.	AA Code No.	Sealed Code No.
ER25 Metric Cont...				
10	-	-	-	338376*
9.5-10	0.374-0.393	-	336828*	-
10-10.5	0.393-0.413	337492	336830	-
10.5	-	-	-	338378*
10-11	0.393-0.433	337348*	-	-
11	-	-	-	338380*
10.5-11	0.413-0.433	-	336831*	-
11-11.5	0.433-0.452	337349	336833	-
11.5	-	-	-	338382*
11-12	0.433-0.472	337350*	-	-
12	-	-	-	338384*
11.5-12	0.452-0.472	-	336835*	-
12-12.5	0.472-0.492	337493	336836	-
12.5	-	-	-	338386*
12-13	0.472-0.511	337352*	-	-
13	-	-	-	338388*
12.5-13	0.492-0.511	-	336838*	-
13-13.5	0.511-0.531	337494	336840	-
13.5	-	-	-	338390*
13-14	0.511-0.551	337354*	-	-
14	-	-	-	338392*
13.5-14	0.531-0.551	-	336841*	-
14-14.5	0.551-0.571	337495	-	-
14.5	-	-	-	338394*
14-15	0.551-0.590	337356*	-	-
15	-	-	-	338396*
14.5-15	0.571-0.590	-	336844*	-
15-15.5	0.590-0.610	337497	336846	-
15.5	-	-	-	338398*
15-16	0.590-0.629	337358*	-	-
16	-	-	-	338400*
15.5-16	0.610-0.629	-	336848*	-
16-16.5	0.629-0.650	337499	-	-
16.5-17	0.650-0.669	337301	-	-
15pc Set	2-16mm	337383	336989	-
21pc Set	6-16mm	-	-	337939

* Part of set ** Not Part of Set

ER32 Collets

Size	Collet Range	Standard Code No.	AA Code No.	Sealed Code No.
ER32 Inch				
3/32	0.0787-0.1180	-	336851	-
1/8	0.1181-0.1570	337703*	336854*	338200
5/32	-	337704*	336856*	338201
3/16	0.1575-0.1970	337706*	336859*	338202
7/32	0.1969-0.2360	337707*	336862*	338203
1/4	0.2362-0.2760	337708*	336865*	338204*
17/64	-	-	-	338301
9/32	-	337709*	336867*	338205*
19/64	-	-	-	338303
5/16	0.2756-0.3150	337711*	336869*	338206*
21/64	-	-	-	338311
11/32	0.3150-0.3540	337712*	336872*	338207*
23/64	-	-	-	338312
3/8	0.3543-0.3940	337713*	336875*	338208*
25/64	-	-	-	338313
13/32	0.3937-0.4330	337714*	336877*	338209*
27/64	-	-	-	338314
7/16	0.4331-0.4720	337716*	336880*	338210*
29/64	-	-	-	338315
15/32	-	337717*	336882*	338211*
31/64	-	-	-	338316
1/2	0.4724-0.5120	337718*	336885*	338212*
33/64	-	-	-	338317
17/32	0.5118-0.5510	337719*	336887*	338213*
35/64	-	-	-	338318
9/16	0.5512-0.5910	337721*	336890*	338214*
37/64	-	-	-	338319
19/32	0.5906-0.6300	337722*	336893*	338215*
39/64	-	-	-	338321

Collet Holder Tooling Systems

Size	Collet Range	Standard Code No.	AA Code No.	Sealed Code No.
<i>ER32 Inch Cont...</i>				
5/8	-	337723*	336895*	338216*
41/64	-	-	-	337924
21/32	0.6299-0.6690	337724*	336898*	338217*
43/64	-	-	-	337925
11/16	0.6693-0.7090	337725*	336900*	338218*
45/64	-	-	-	337926
23/32	-	337726*	336903*	338219*
47/64	-	-	-	337927
3/4	0.7087-0.7480	337727*	336906*	338220*
49/64	-	-	-	337928
25/32	-	337605	336908	338322
17pc Set	1/8-3/4	-	-	337940
21pc Set	1/8-3/4	337407	336996	-
<i>ER32 Metric</i>				
2-2.5	0.078-0.098	337415	336852	-
2-3	0.078-0.118	337361*	-	-
3	-	-	-	338335
2.5-3	0.098-0.118	-	336853*	-
2.5-3.5	0.098-0.137	337359	-	-
3.5	-	-	-	338351
3-3.5	0.118-0.137	-	336855	-
3-4	0.118-0.157	337362*	-	-
4	-	-	-	338353
3.5-4	0.137-0.157	-	336857*	-
4-4.5	0.157-0.177	337217	336858	-
4.5	-	-	-	338333
4-5	0.157-0.196	337363*	-	-
5	-	-	-	338355
4.5-5	0.177-0.196	-	336860*	-
5-5.5	0.196-0.217	337218	336861	-
5.5	-	-	-	338363
5-6	0.196-0.236	337364*	-	-
6	-	-	-	338320
5.5-6	0.217-0.236	-	336863*	-
6-6.5	0.236-0.256	337219	336864	-
6.5	-	-	-	338365
6-7	0.236-0.275	337365*	-	-
7	-	-	-	338357
6.5-7	0.256-0.275	-	336866*	-
7-7.5	0.275-0.295	337289	336868	-
7.5	-	-	-	338367
7-8	0.275-0.314	337366*	-	-
8	-	-	-	338324
7.5-8	0.295-0.314	-	336870*	-
8-8.5	0.314-0.335	337221	336871	-
8.5	-	-	-	338369
8-9	0.314-0.354	337367*	-	-
9	-	-	-	338359
8.5-9	0.335-0.354	-	336873*	-
9-9.5	0.354-0.374	337222	336874	-
9.5	-	-	-	338361
9-10	0.354-0.393	337368*	-	-
10	-	-	-	338328
9.5-10	0.374-0.393	-	336876*	-
10-10.5	0.393-0.413	337223	336878	-
10.5	-	-	-	338404*
10-11	0.393-0.433	337369*	-	-
11	-	-	-	338406*
10.5-11	0.413-0.433	-	336879*	-
10.5-11.5	0.413-0.452	337357	-	-
11.5	-	-	-	338371*
11-11.5	0.433-0.452	-	336881	-
11-12	0.433-0.472	337370*	-	-
12	-	-	-	338332*
11.5-12	0.452-0.472	-	336883*	-
12-12.5	0.472-0.492	337227	336884	-
12.5	-	-	-	338408*
12-13	0.472-0.511	337371*	-	-
13	-	-	-	338410*
12.5-13	0.492-0.511	-	336886*	-
13-13.5	0.511-0.531	337229	336888	-
13.5	-	-	-	338412*

Size	Collet Range	Standard Code No.	AA Code No.	Sealed Code No.
<i>ER32 Metric Cont...</i>				
13-14	0.511-0.551	337372*	-	-
14	-	-	-	338414*
13.5-14	0.531-0.551	-	336889*	-
14-14.5	0.551-0.571	337249	336891	-
14.5	-	-	-	338416*
14-15	0.551-0.590	337373*	-	-
15	-	-	-	338418*
14.5-15	0.571-0.590	-	336892*	-
15-15.5	0.590-0.610	337255	336894	-
15.5	-	-	-	338420*
15-16	0.590-0.629	337374*	-	-
16	-	-	-	338422*
15.5-16	0.610-0.629	-	336896*	-
16-16.5	0.629-0.650	337256	336897	-
16.5	-	-	-	338424*
16-17	0.629-0.669	337375*	-	-
17	-	-	-	338426*
16.5-17	0.650-0.669	-	336899*	-
17-17.5	0.669-0.689	337272	336901	-
17.5	-	-	-	338428*
17-18	0.669-0.708	337376*	-	-
18	-	-	-	338430*
17.5-18	0.689-0.708	-	336902*	-
18-18.5	0.708-0.728	337215	336904	-
18.5	-	-	-	338432*
18-19	0.708-0.748	337377*	-	-
19	-	-	-	338434*
18.5-19	0.728-0.748	-	336905*	-
18.5-19.5	0.728-0.767	337355	-	-
19.5	-	-	-	338436*
19-19.5	0.748-0.767	-	336907	-
19-20	0.748-0.787	337378*	-	-
20	-	-	-	338438*
19.5-20	0.767-0.787	-	336909*	-
18pc Set	3-20mm	337384	336990	-
20pc Set	10.5-20mm	-	-	337942

* Part of Set

ER40 Collets

Size	Collet Range	Standard Code No.	AA Code No.	Sealed Code No.
<i>ER40 Inch</i>				
1/8	0.1181-0.1570	337728*	336910*	338238
5/32	-	337729*	336912	338239
3/16	0.1575-0.1970	337731*	336915*	338240
7/32	0.1969-0.2360	337732*	336918	338241
1/4	0.2362-0.2760	337733*	336921*	338242
9/32	-	337734*	336923	338243
5/16	0.2756-0.3150	337736*	336925*	338244
11/32	0.3150-0.3540	337737*	336928	338245
3/8	0.3543-0.3940	337738*	336931*	338246
13/32	0.3937-0.4330	337739*	336933	338247
7/16	0.4331-0.4720	337741*	336936*	338248
15/32	-	337742*	336938	338249
1/2	0.4724-0.5120	337743*	336941*	338250
17/32	0.5118-0.5510	337744*	336943	338251
9/16	0.5512-0.5910	337746*	336946*	338252
19/32	-	337747*	336949	338253
5/8	0.5906-0.6300	337748*	336951*	338254
21/32	0.6299-0.6690	337749*	336954	338255
11/16	0.6693-0.7090	337751*	336956*	338256
23/32	-	337752*	336959	338257
3/4	0.7087-0.7480	337753*	336962*	338258
25/32	0.7480-0.7870	337754*	336964	338259
13/16	0.7874-0.8270	337756*	336967*	338260
27/32	0.8268-0.8660	337757*	336969	338261
7/8	0.8661-0.9060	337758*	336972*	338262
29/32	-	337759*	336975	338263
15/16	0.9055-0.9450	337761*	336977*	338264
31/32	0.9449-0.9840	337762*	336980	338265
1	0.9843-1.0200	337763*	336982*	338266
15pc Set	1/8-1	-	336997	-
29pc Set	1/8-1	337409	-	-

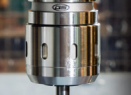

Size	Collet Range	Standard Code No.	AA Code No.	Sealed Code No.
ER40 Metric				
3.0	0.1181	-	336985	-
3-3.5	0.118-0.137	337545	336911	-
3-4	0.118-0.157	337501*	-	-
3.5-4	0.137-0.157	-	336913*	-
4-4.5	0.157-0.177	337546	336914	-
4-5	0.157-0.196	337502*	-	-
4.5-5	0.177-0.196	-	336916*	-
5-5.5	0.196-0.216	337547	336917	-
5-6	0.196-0.236	337503*	-	-
6	-	-	-	338441
5.5-6	0.216-0.236	-	336919*	-
6-6.5	0.236-0.256	337548	336920	-
6.5	-	-	-	338435
6-7	0.236-0.275	337505*	-	-
7	-	-	-	338443
6.5-7	0.256-0.275	-	336922*	-
7-7.5	0.275-0.295	337549	336924	-
7.5	-	-	-	338437
7-8	0.275-0.314	337506*	-	-
8	-	-	-	338445
7.5-8	0.295-0.314	-	336926*	-
8-8.5	0.314-0.335	337554	336927	-
8.5	-	-	-	338439
8-9	0.314-0.354	337507*	-	-
9	-	-	-	338447
8.5-9	0.335-0.354	-	336929*	-
9-9.5	0.354-0.374	337557	336930	-
9.5	-	-	-	338449
9-10	0.354-0.393	337509*	-	-
10	-	-	-	338440*
9.5-10	0.374-0.393	-	336932*	-
10-10.5	0.393-0.413	337558	336934	-
10.5	-	-	-	338442*
10-11	0.393-0.433	337510*	-	-
11	-	-	-	338444*
10.5-11	0.413-0.433	-	336935*	-
10.5-11.5	0.413-0.452	337498	-	-
11.5	-	-	-	338446*
11-11.5	0.433-0.452	-	336937	-
11-12	0.433-0.472	337511*	-	-
12	-	-	-	338448*
11.5-12	0.452-0.472	-	336939*	-
12-12.5	0.472-0.492	337559	336940	-
12.5	-	-	-	338450*
12-13	0.472-0.511	337513*	-	-
13	-	-	-	338452*
12.5-13	0.492-0.511	-	336942*	-
13-13.5	0.511-0.531	336562	336944	-
13.5	-	-	-	338454*
13-14	0.511-0.551	337514*	-	-
14	-	-	-	338456*
13.5-14	0.531-0.551	-	336945*	-
14-14.5	0.551-0.571	337563	336947	-
14.5	-	-	-	338458*
14-15	0.551-0.590	337515*	-	-
15	-	-	-	338460*
14.5-15	0.571-0.590	-	336948*	-
15-15.5	0.590-0.610	337564	336950	-
15.5	-	-	-	338462*
15-16	0.590-0.629	337517*	-	-
16	-	-	-	338464*
15.5-16	0.610-0.629	-	336952*	-
16-16.5	0.629-0.650	337567	336953	-
16.5	-	-	-	338468*
16-17	0.629-0.669	337518*	-	-
17	-	-	-	338470*
16.5-17	0.650-0.669	-	336955*	-
17-17.5	0.669-0.689	337568	336957	-
17.5	-	-	-	338472*
17-18	0.669-0.708	337519*	-	-
18	-	-	-	338474*
17.5-18	0.689-0.708	-	336958*	-
18-18.5	0.708-0.728	337569	336960	-

Size	Collet Range	Standard Code No.	AA Code No.	Sealed Code No.
ER40 Metric Cont...				
18.5	-	-	-	338476*
18-19	0.708-0.748	337521*	-	-
19	-	-	-	338478*
18.5-19	0.728-0.748	-	336961*	-
18.5-19.5	0.728-0.767	337496	-	-
19.5	-	-	-	338480*
19-19.5	0.748-0.767	-	336963	-
19-20	0.748-0.787	337522*	-	-
20	-	-	-	338482*
19.5-20	0.767-0.787	-	336965*	-
20-20.5	0.787-0.807	337572	336966	-
20.5	-	-	-	338484*
20-21	0.787-0.826	337523*	-	-
21	-	-	-	338486*
20.5-21	0.807-0.826	-	336968*	-
21-21.5	0.826-0.846	337573	336970	-
21.5	-	-	-	338488*
21-22	0.826-0.866	337524*	-	-
22	-	-	-	338490*
21.5-22	0.846-0.866	-	336971*	-
22-22.5	0.866-0.886	337574	336973	-
22.5	-	-	-	338492*
22-23	0.866-0.905	337525*	-	-
23	-	-	-	338494*
22.5-23	0.886-0.905	-	336974*	-
23-23.5	0.905-0.925	337577	336976	-
23.5	-	-	-	338496*
23-24	0.905-0.944	337526*	-	-
24	-	-	-	338498*
23.5-24	0.925-0.944	-	336978*	-
24-24.5	0.944-0.965	337578	336979	-
24.5	-	-	-	338500*
24-25	0.944-0.984	337527*	-	-
25	-	-	-	338502*
24.5-25	0.965-0.984	-	336981*	-
25-25.5	0.984-1.004	337579	336983	-
25.5	-	-	-	338504*
25-26	0.984-1.023	337528*	-	-
26	-	-	-	338506*
25.5-26	1.004-1.023	-	336984*	-
23pc Set	4-26mm	337386	336991	-
33pc Set	10-26mm	-	-	337944

* Part of Set

ER50 Collets

Size	Collet Range	Standard Code No.	AA Code No.	Sealed Code No.
ER50 Metric				
10-12	0.394-0.472	337450*	-	-
12-14	0.472-0.551	337452*	-	-
14-16	0.551-0.630	337454*	-	-
16-18	0.630-0.709	337456*	-	-
18-20	0.709-0.789	337458*	-	-
20-22	0.789-0.866	337460*	-	-
22-24	0.866-0.945	337461*	-	-
24-26	0.945-1.024	337462*	-	-
26-28	1.024-1.102	337464*	-	-
28-30	1.102-1.181	337466*	-	-
30-32	1.181-1.260	337468*	-	-
11pc Set	12-32mm	337387	-	-

* Part of Set

ASIMETO

High-precision measuring instruments, competitively priced!



CAT Taper SA High Precision Collet Chucks



LIMITED SUPPLY
While quantities last.

Taper	Collet Series	Collet Range	Gauge Length	Code No.
CAT40				
CT40	SA10	0.069-0.394	3.54	531756
CT40	SA10	0.069-0.394	4.72	531758
CT40	SA16	0.108-0.630	3.54	531762
CT40	SA16	0.108-0.630	5.91	531766
CT40	SA25	0.630-1.00	3.54	531768
CAT50				
CT50	SA10	0.069-0.394	4.13	531776
CT50	SA16	0.108-0.630	4.13	531782
CT50	SA25	0.630-1.00	4.13	531788

SA Replacement Parts



LIMITED SUPPLY
While quantities last.

Part	Series	Description	Code No.
Replacement Collet Chuck Nuts			
	SA10	Nut (Hex)	536588
	SA16	Nut (Notched)	536590
	SA25	Nut (Notched)	536592
Collet Chuck Nut Wrenches			
	SA10	Chuck Wrench	536580
	SA16	Chuck Wrench	536582
	SA25	Chuck Wrench	536584
Collet Extractors			
	SA10	Collet Extractor	536572
	SA16	Collet Extractor	536574
	SA25	Collet Extractor	536576

SA10, SA16 & SA25 Collets

Size	Collapse Range (mm)	Collapse Range (in.)	SA10 Code No.	SA16 Code No.	SA25 Code No.
SA Inch					
1/8	-	-	338602	338674	-
3/16	-	-	338604	338676	-
1/4	-	-	338606	338678	338736
5/16	-	-	338608	338680	338738
3/8	-	-	338610	338682	338740
7/16	-	-	-	338684	338742
1/2	-	-	-	338686	338744
9/16	-	-	-	338688	-
5/8	-	-	-	338690	338746
3/4	-	-	-	-	338748
SA Metric					
2.0mm	1.75-2.0	0.068-0.078	338564	338614	-
2.25mm	2.0-2.25	0.078-0.088	338566	-	-
2.5mm	2.25-2.5	0.088-0.098	338568	338616	-
3.0mm	2.75-3.0	0.108-0.118	338572	338618	-
3.5mm	3.0-3.5	0.118-0.137	338574	338620	-
4.0mm	3.5-4.0	0.137-0.157	338576	338622	-
4.5mm	4.0-4.5	0.157-0.177	338578	338624	-
5.0mm	4.5-5.0	0.177-0.196	338580	338626	-
5.5mm	5.0-5.5	0.196-0.216	338582	338628	-
6.0mm	5.5-6.0	0.216-0.236	338583	338630	-
6.5mm	6.0-6.5	0.236-0.255	338584	338632	-
7.0mm	6.5-7.0	0.255-0.275	338586	338634	-
7.5mm	7.0-7.5	0.275-0.295	338588	338636	-
8.0mm	7.5-8.0	0.295-0.314	338590	338638	-
8.5mm	8.0-8.5	0.314-0.334	338592	338640	-
9.0mm	8.5-9.0	0.334-0.354	338594	338642	-
9.5mm	9.0-9.5	0.354-0.374	338596	338644	-
10.0mm	9.5-10.0	0.374-0.393	338598	338646	-
10.5mm	10.0-10.5	0.393-0.413	-	338648	-
11.0mm	10.5-11.0	0.413-0.433	-	338650	-
11.5mm	11.0-11.5	0.433-0.452	-	338652	-
12.0mm	11.5-12.0	0.452-0.472	-	338654	-
12.5mm	12.0-12.5	0.472-0.492	-	338656	-
13.0mm	12.5-13.0	0.492-0.511	-	338658	-
13.5mm	13.0-13.5	0.511-0.531	-	338660	-
14.0mm	13.5-14.0	0.531-0.551	-	338662	-
14.5mm	14.0-14.5	0.551-0.570	-	338664	-
15.0mm	14.5-15.0	0.570-0.590	-	338666	-

LIMITED SUPPLY
While quantities last.



Size	Collapse Range (mm)	Collapse Range (in.)	SA10 Code No.	SA16 Code No.	SA25 Code No.
<i>SA Cont...</i>					
15.5mm	15.0-15.5	0.590-0.610	-	338668	-
16.0mm	15.5-16.0	0.610-0.629	-	338670	-
16.5mm	16.0-16.5	0.629-0.649	-	-	338694
17.0mm	16.5-17.0	0.649-0.669	-	-	338696
17.5mm	17.0-17.5	0.669-0.688	-	-	338698
18.0mm	17.5-18.0	0.688-0.708	-	-	338700
18.5mm	18.0-18.5	0.708-0.728	-	-	338702
19.0mm	18.5-19.0	0.728-0.748	-	-	338704
20.0mm	19.5-20.0	0.767-0.787	-	-	338708
20.5mm	20.0-20.5	0.787-0.807	-	-	338710
21.0mm	20.5-21.0	0.807-0.826	-	-	338712
21.5mm	21.0-21.5	0.826-0.846	-	-	338714
22.0mm	21.5-22.0	0.846-0.866	-	-	338716
23.0mm	22.5-23.0	0.885-0.905	-	-	338720
24.0mm	23.5-24.0	0.925-0.944	-	-	338724
24.5mm	24.0-24.5	0.944-0.964	-	-	338726
25.0mm	24.5-25.0	0.964-0.984	-	-	338728
25.4mm	25.0-25.4	0.984-1.000	-	-	338730



Shrink Fit Holders

Choose Shrink Fit Holders when maximum gripping power with exceptional concentricity is needed. The tool is gripped 360° along the entire length of bore resulting in an evenly distributed clamping force, allowing for greater speeds and feeds, better finishes, extended tool life and increased productivity.

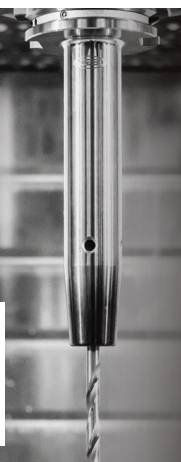

TG Collet Dimensional Data

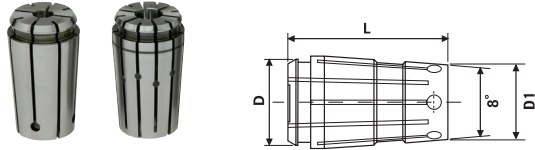

Style	D	D1	L	Collet Range
TG25	0.425	0.325	0.709	3/64-1/4
TG50	0.760	0.594	1.437	1/8-1/2
TG75	1.063	0.871	1.844	3/64-3/4
TG100	1.278	1.121	2.386	3/64-1
TG150	1.875	1.678	3.000	1/2-1-1/2

CAT Taper TG Collet Chucks

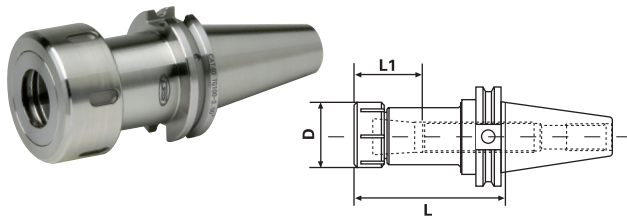

Taper	Collet Series	Collet Range	L	L1	D	Tightening Torque (Nm)	Code No.
CAT40							
CT40	TG75	3/64-3/4	3.00	1.61	1.89	81.3	531284
CT40	TG75	3/64-3/4	5.00	1.61	1.89	81.3	531286
CT40	TG100	3/64-1	3.00	2.13	2.50	81.3	531288
CT40	TG100	3/64-1	3.50	2.13	2.50	81.3	531290
CT40	TG100	3/64-1	5.50	2.13	2.50	81.3	531292
CT40	TG150	1/2-1-1/2	6.00	2.88	3.50	94.9	531294
CAT50							
CT50	TG75	3/64-3/4	3.50	1.61	1.89	81.3	531296
CT50	TG100	3/64-1	3.50	2.13	2.50	81.3	531300
CT50	TG100	3/64-1	5.50	2.13	2.50	81.3	531302
CT50	TG100	3/64-1	7.50	2.13	2.50	81.3	531304
CT50	TG100	3/64-1	10.00	2.13	3.50	81.3	531306
CT50	TG150	1/2-1-1/2	3.50	2.88	3.50	94.9	531308
CT50	TG150	1/2-1-1/2	6.00	2.88	3.50	94.9	531310

BT Taper TG Collet Chucks

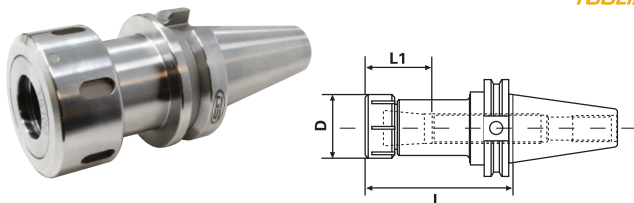

Taper	Collet Series	Collet Range	L	L1	D	Tightening Torque (Nm)	Code No.
BT30							
BT30	TG75	3/64-3/4	2.50	1.61	1.89	81.3	532128†
BT30	TG100	3/64-1	3.94	2.24	2.50	81.3	532130†
BT40							
BT40	TG75	3/64-3/4	3.00	1.61	1.89	81.3	532132
BT40	TG100	3/64-1	3.50	2.13	2.50	81.3	532134
BT40	TG100	3/64-1	5.50	2.13	2.50	81.3	532136
BT50							
BT50	TG100	3/64-1	4.00	2.13	2.50	81.3	532139
BT50	TG100	3/64-1	6.00	2.13	2.50	81.3	532140

† Not DIN Coolant

NMTB Taper TG Collet Chucks

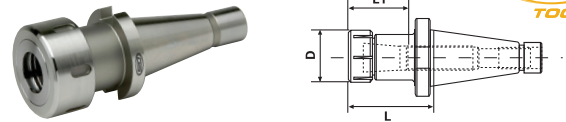

Taper	Collet Series	Collet Range	L	L1	D	Tightening Torque (Nm)	Code No.
NMTB40	TG100	3/64-1	3.00	2.12	2.50	81.3	534304
NMTB50	TG75	3/64-3/4	3.00	1.61	1.89	81.3	534308
NMTB50	TG100	3/64-1	3.50	2.12	2.50	81.3	534310

R8 Taper TG Collet Chuck

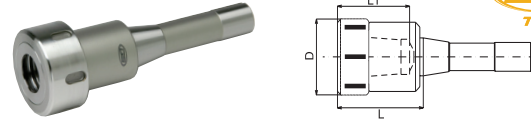

Taper	Collet Series	Collet Range	L	L1	D	Tightening Torque (Nm)	Code No.
R8	TG100	3/64-1	3.25	2.17	2.50	81.3	534314

Morse Taper TG Collet Chucks

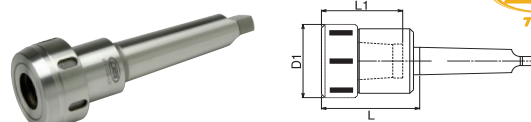

Taper	Collet Series	Collet Range	L	L1	D	Tightening Torque (Nm)	Code No.
MT3	TG100	3/64-1	3.25	2.73	2.50	81.3	534322
MT4	TG100	3/64-1	3.25	2.73	2.50	81.3	534324

Straight Shank TG Collet Chucks

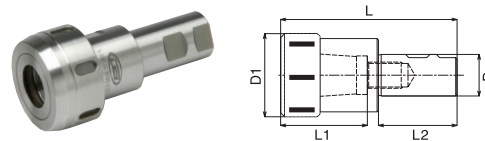

Shank Dia.	Collet Series	Collet Range	L	L1	L2	D1	Tightening Torque (Nm)	Code No.
1-1/2	TG100	3/64-1	9.00	2.73	6.00	2.50	81.3	534320

TG Replacement Parts



Part	Series	Description	Code No.
Replacement Backup Screws			
	TG75	Backup Screw	534778
	TG100	Backup Screw	534782
	TG150	Backup Screw	534786
	TG150	Backup Screw (Coolant)	534788
Replacement Collet Chuck Nuts			
	TG75	*Nut – Tightening Torque (Nm) – 81.3	534760
	TG100	*Nut – Tightening Torque (Nm) – 81.3	534762
	TG150	*Nut – Tightening Torque (Nm) – 94.9	534764
	TG75	SOLID Nut – Tightening Torque (Nm) – 81.3	534830
TG100	SOLID Nut – Tightening Torque (Nm) – 81.3	534832	
Collet Chuck Nut Wrenches			
	TG75	Chuck Wrench	534772
	TG100	Chuck Wrench	534774
	TG150	Chuck Wrench	534776

* Photo Shown / This style is supplied with chuck



TG75, TG100 & TG150 Standard & Sealed Collets

TG75

- 1/64" collapse per collet
- 0.0005" in TIR precision per DIN 6341
- 80 ft/lbs maximum tightening torque

Sealed Collets

- Sealed for coolant-through applications
- Pressure resistance tested to 1000 psi
- Sealed with rubber

TG100

- 1/64" collapse per collet
- 0.0005" in TIR precision per DIN 6341
- 90 ft/lbs maximum tightening torque

Sealed Collets

- Sealed for coolant-through applications
- Pressure resistance tested between 650 - 750 psi
- Sealed with rubber

TG150

- Unique 8" taper design affords highest gripping power
- True double angle, for extreme concentricity
- 16 jaws giving powerful gripping and parallel clamping
- A unique self releasing system is built into the collet and clamping nut to eliminate cutting tools sticking in collets
- 1/64" collapse per collet
- 0.0005" in TIR precision per DIN 6341



STANDARD SEALED

Size (in.)	TG75 Standard Code No.	TG75 Sealed Code No.	TG100 Standard Code No.	TG100 Sealed Code No.	TG150 Standard Code No.
3/64	334790	-	334418	-	-
1/16	334791	-	-	-	-
5/64	334792	-	334423	-	-
3/32	334800	-	334425N	-	-
7/64	334801	-	334426	-	-
1/8	334802	334843	334427N	-	-
9/64	334803	334844	334428	-	-
5/32	334804	334845	334429N	334907	-
11/64	334805	334846	334430	334908	-
3/16	334806	334847	334431N	334909	-
13/64	334807	334848	334432	334910	-
7/32	334808	334849	334433N	334911	-
15/64	334809	334850	334434	334912	-
1/4	334810	334851	334435N	334913	-
17/64	334811	334852	334436	334914	-
9/32	334812	334853	334437N	334915	-
19/64	334813	334854	334438	334916	-
5/16	334814	334855	334439N	334917	-
21/64	334815	334856	334440	334918	-
11/32	334816	334857	334441N	334919	-
23/64	334817	334858	334442	334920	-
3/8	334818	334859	334443N	334921	-
25/64	334819	334860	334444	334922	-
13/32	334820	334861	334445N	334923	-
27/64	334821	334862	334446	334924	-
7/16	334822	334863	334447N	334925	-
29/64	334823	334864	334448	334926	-
15/32	334824	334865	334449N	334927	-
31/64	334825	334866	334450	334928	-
1/2	334826	334867	334451N	334929	334485N
33/64	334827	334868	334452	334930	334486
17/32	334828	334869	334453N	334931	334487N
35/64	334829	334870	334454	334932	334488
9/16	334830	334871	334455N	334933	334489N
37/64	334831	334872	334456	334934	334490
19/32	334832	334873	334457N	334935	334491N
39/64	334833	334874	334458	334936	334492
5/8	334834	334875	334459N	334937	334493N
41/64	334835	334876	334460	334938	334494
21/32	334836	334877	334461N	334939	334495N
43/64	334837	334878	334462	334940	334496
11/16	334838	334879	334463N	334941	334497N
45/64	334839	334880	334464	334942	334498
23/32	334840	334881	334465N	334943	334499N
47/64	334841	334882	334466	334944	334500
3/4	334842	334883	334467N	334945	334501N
49/64	-	-	334468	334946	334502
25/32	-	-	334469N	334947	334503N
51/64	-	-	334470	334948	334504
13/16	-	-	334471N	334949	334505N
53/64	-	-	334472	334950	334506
27/32	-	-	334473N	334951	334507N
55/64	-	-	334474	334952	334508
7/8	-	-	334475N	334953	334509N
57/64	-	-	334476	334954	334510
29/32	-	-	334477N	334955	334511N
59/64	-	-	334478	334956	334512
15/16	-	-	334479N	334957	334513N
61/64	-	-	334480	334958	334514
31/32	-	-	334481N	334959	334515N
63/64	-	-	334482	334960	334516
1	-	-	334483N	334961	334517N
1-1/64	-	-	-	-	334518
1-1/32	-	-	-	-	334519N

Size (in.)	TG75 Standard Code No.	TG75 Sealed Code No.	TG100 Standard Code No.	TG100 Sealed Code No.	TG150 Standard Code No.
1-3/64	-	-	-	-	334520
1-1/16	-	-	-	-	334521N
1-5/64	-	-	-	-	334522
1-3/32	-	-	-	-	334523N
1-7/64	-	-	-	-	334524
1-1/8	-	-	-	-	334525N
1-9/64	-	-	-	-	334526
1-5/32	-	-	-	-	334527N
1-11/64	-	-	-	-	334528
1-3/16	-	-	-	-	334529N
1-13/64	-	-	-	-	334530
1-7/32	-	-	-	-	334531N
1-15/64	-	-	-	-	334532
1-1/4	-	-	-	-	334533N
1-17/64	-	-	-	-	334534
1-9/32	-	-	-	-	334535N
1-19/64	-	-	-	-	334536
1-5/16	-	-	-	-	334537N
1-21/64	-	-	-	-	334538
1-11/32	-	-	-	-	334539N
1-23/64	-	-	-	-	334540
1-3/8	-	-	-	-	334541N
1-25/64	-	-	-	-	334542
1-13/32	-	-	-	-	334543N
1-27/64	-	-	-	-	334544
1-7/16	-	-	-	-	334545N
1-29/64	-	-	-	-	334546
1-15/32	-	-	-	-	334547N
1-31/64	-	-	-	-	334548
1-1/2	-	-	-	-	334549N

TG75, TG100 Tap Collets

- For synchronous, rigid tapping operations using TG collet chuck
- Collet bore is exact tool diameter with square drive for accuracy and rigidity



Tap Inch	Shank Dia. (in.)	Size of Square (in.)	TG75 Code No.	TG100 Code No.
0-6	0.141	0.110	334884	334963
8	0.168	0.131	334885	334964
10	0.194	0.152	334886	334965
12	0.220	0.165	334887	334966
1/4	0.255	0.191	334888	334967
5/16	0.318	0.238	334889	334968
3/8	0.381	0.286	334890	334969
7/16	0.323	0.242	334891	334970
1/2	0.367	0.275	334892	334971
9/16	0.429	0.322	334893	334972
5/8	0.480	0.360	334894	334973
11/16	0.542	0.406	334895	334974
3/4	0.590	0.442	334896	334975
13/16	0.652	0.489	-	334976
7/8	0.697	0.523	-	334977
15/16	0.760	0.570	-	334978
1	0.800	0.600	-	334979
NPT				
1/16, 1/8 NPT-ss*	0.3125	0.234	334897	334980
1/8 NPT-LS*	0.4375	0.328	334898	334981
1/4 NPT	0.5625	0.421	334899	334982
3/8 NPT	0.7000	0.531	-	334983
1/2 NPT	0.6875	0.515	-	334984

*ss = small shank *LS = large shank

DA Collet Dimensional Data

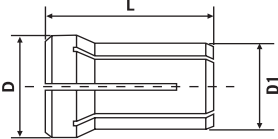

Collet	D	D1	L	Collet Range
100DA	0.769	0.635	1.441	3/64-9/16
180DA	1.035	0.873	1.637	3/64-3/4
200DA	0.539	0.453	1.193	3/64-3/8
300DA	0.375	0.300	1.000	3/64-1/4

DA Replacement Parts



Part	Series	Description	Code No.
Replacement Backup Screws			
	DA180	Backup Screw	534288
Replacement Collet Chuck Nuts			
	DA100	Nut, Complete Replacement	534264
	DA180	Nut, Complete Replacement	534270
	DA200	Nut, Complete Replacement	534276
	DA300	Nut, Complete Replacement	534277

CAT40 & CAT50 DA Collet Chucks

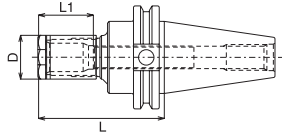

Taper	Collet Series	Collet Range	L	L1	D	Nut Tightening Torque (ft. lbs.)	Code No.
CAT40							
CT40	DA100	3/64-9/16	3.50	1.15	1.06	35	531270
CT40	DA100	3/64-9/16	6.00	1.15	1.06	35	531272
CT40	DA180	3/64-3/4	4.00	1.50	1.44	40	531273
CT40	DA180	3/64-3/4	6.00	1.50	1.44	40	531274
CT40	DA200	3/64-3/8	3.00	1.03	0.86	30	531275
CT40	DA300	3/64-1/4	3.00	0.84	0.55	25	531276
CAT50							
CT50	DA180	3/64-3/4	4.00	1.50	1.44	40	531278
CT50	DA180	3/64-3/4	6.00	1.50	1.44	40	531280

DA100, DA180, DA200 & DA300 Collets



- Collapse - 1/32"
- 0.001" TIR collet accuracy
- Made from 4140 alloy steel for improved strength, hardness, wear resistance, and corrosion resistance
- For most drilling, reaming and tapping applications



Fractional Inch	Decimal (in.)	DA100 Code No.	DA180 Code No.	DA200 Code No.	DA300 Code No.
3/64	0.047	331323	331523	331297	331277
1/16	0.062	331325	331525	331299	331283
5/64	0.078	331327	331527	331301	331285
3/32	0.094	331329	331529	331303	331287
7/64	0.109	331333	331533	331305	331290
1/8	0.125	331335	331535	331307	331292
9/64	0.141	331337	331537	331309	331294
5/32	0.156	331339	331539	331311	331296
11/64	0.172	331341	331541	331313	331298
3/16	0.188	331343	331543	331315	331300
13/64	0.203	331345	331545	331302	331289
7/32	0.219	331347	331547	331304	331291
15/64	0.234	331349	331549	331306	331293
1/4	0.250	331351	331551	331308	331295
17/64	0.266	331353	331553	331310	-
9/32	0.281	331355	331555	331312	-
19/64	0.297	331357	331557	331314	-
5/16	0.312	331359	331559	331316	-
21/64	0.328	331503	331561	331318	-
11/32	0.344	331505	331563	331320	-
23/64	0.359	331507	331565	331317	-
3/8	0.375	331322	331567	331319	-
25/64	0.391	331509	331569	331321	-
13/32	0.406	331324	331571	-	-
27/64	0.422	331511	331573	-	-
7/16	0.438	331326	331575	-	-
29/64	0.453	331513	331577	-	-
15/32	0.469	331328	331579	-	-
31/64	0.484	331515	331581	-	-
1/2	0.500	331330	331583	-	-
33/64	0.516	331517	331585	-	-
17/32	0.531	331332	331587	-	-
35/64	0.547	331519	331589	-	-
9/16	0.562	331521	331334	-	-
37/64	0.578	-	331595	-	-
19/32	0.594	-	331336	-	-
39/64	0.609	-	331597	-	-
5/8	0.625	-	331338	-	-
41/64	0.641	-	331601	-	-
21/32	0.656	-	331340	-	-
43/64	0.672	-	331603	-	-
11/16	0.688	-	331342	-	-
45/64	0.703	-	331605	-	-
23/32	0.719	-	331344	-	-
47/64	0.734	-	331607	-	-
3/4	0.750	-	331346	-	-

BT30 & BT40 DA Collet Chucks

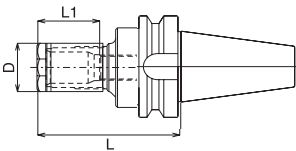

Taper	Collet Series	Collet Range	L	L1	D	Nut Tightening Torque (ft. lbs.)	Code No.
BT40							
BT30	DA100	3/64-9/16	3.00	1.15	1.06	35	532108
BT30	DA180	3/64-3/4	3.00	1.51	1.44	40	532110
BT30	DA200	3/64-3/8	3.00	1.03	0.86	30	532112
BT30	DA300	3/64-1/4	3.00	1.04	0.55	25	532125
BT50							
BT40	DA100	3/64-9/16	6.00	1.15	1.06	35	532118
BT40	DA180	3/64-3/4	4.00	1.51	1.44	40	532120
BT40	DA180	3/64-3/4	6.00	1.51	1.44	40	532122
BT40	DA200	3/64-3/8	3.00	1.03	0.86	30	532124

DA Collet Chuck Extensions

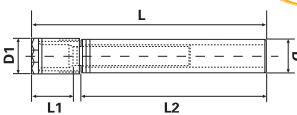

Collet Series	Collet Range	Shank Dia. (D)	O.A.L. L	L1	L2	D1	Code No.
DA100	3/64-9/16	1	5.00	1.66	3.00	1.06	534220
DA100	3/64-9/16	1	7.50	1.66	5.50	1.06	534222
DA180	3/64-3/4	1-1/4	5.00	1.83	3.00	1.44	534224
DA180	3/64-3/4	1-1/4	7.50	1.83	5.50	1.44	534226
DA200	3/64-3/8	3/4	4.50	1.34	3.00	0.86	534228
DA200	3/64-3/8	3/4	7.00	1.34	5.50	0.86	534230
DA300	3/64-1/4	1/2	6.80	1.30	5.50	0.51	534232



CAT40 & CAT50 ER Milling Chucks

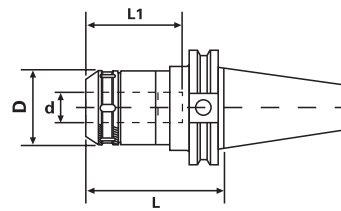

Taper	Collet Series	Collet Range	d	L	L1	D	Tightening Torque (Nm)	GS Code No.	GS Dual Contact Code No.
CAT40									
CT40	GS 3/4	0.125-0.750	0.750	3.54	3.15	2.05	50-70	531253	521253
CT40	GS 3/4	0.125-0.750	0.750	4.14	3.15	2.05	50-70	531250	-
CT40	GS 1	0.125-1.00	1.00	3.54	3.15	2.41	50-70	531255†	521255†
CT40	GS 1	0.125-1.00	1.00	4.14	3.15	2.41	50-70	531254	-
CT40	GS 1-1/4	0.187-1.25	1.25	3.54	3.34	2.88	60-80	531257†	521257†
CT40	GS 1-1/4	0.187-1.25	1.25	4.14	3.34	2.88	60-80	531256	-
CT40	GS 1-1/4	0.187-1.25	1.25	5.32	4.73	2.88	60-80	531258	-
CAT50									
CT50	GS 3/4	0.125-0.750	0.750	4.14	3.15	2.05	50-70	531260	-
CT50	GS 3/4	0.125-0.750	0.750	5.32	3.15	2.05	50-70	531262	-
CT50	GS 3/4	0.125-0.750	0.750	6.49	3.15	2.05	50-70	531263	-
CT50	GS 1	0.125-1.00	1.00	4.14	3.15	2.41	50-70	531264	-
CT50	GS 1-1/4	0.187-1.25	1.25	3.54	4.73	2.88	60-80	531265	-
CT50	GS 1-1/4	0.187-1.25	1.25	4.14	4.73	2.88	60-80	531266	521266
CT50	GS 1-1/4	0.187-1.25	1.25	5.32	4.73	2.88	60-80	531268	-
CT50	GS 1-1/4	0.187-1.25	1.25	6.49	4.73	2.88	60-80	531269	-

BT Taper Milling Chucks

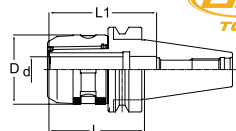

Taper	Collet Series	Collet Range	d	L	L1	D	Code No.
BT30							
BT30	GS 3/4	0.125-0.750	0.750	3.55	3.15	2.05	532096†
BT40							
BT40	GS 3/4	0.125-0.750	0.750	4.14	3.15	2.05	532098
BT40	GS 3/4	0.125-0.750	0.750	4.73	3.15	2.05	532100
BT40	GS 1	0.125-1.00	1.00	4.14	3.15	2.41	532102
BT40	GS 1-1/4	0.187-1.25	1.25	4.14	3.34	2.88	532104
BT50							
BT50	GS 1-1/4	0.187-1.25	1.25	4.20	3.34	2.88	532113

† Not DIN Coolant

HSK Milling Chucks

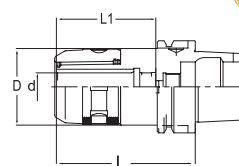

Taper	Collet Series	Collet Range	d	L	L1	D	Code No.
HSK63A							
HSK63A	GS3/4	0.125-0.750	0.750	3.740	2.480	2.047	536154
HSK63A	GS1	0.125-1.000	1.000	5.118	3.150	2.362	536160
HSK63A	GS1-1/4	0.187-1.250	1.250	4.331	3.268	2.717	536162
HSK100A							
HSK100A	GS3/4	0.125-0.750	0.750	5.315	3.150	2.047	536170
HSK100A	GS32	3mm - 32mm	32mm	5.315	4.055	2.717	536180
HSK100A	GS2	1.000-2.000	2.000	4.921	3.543	4.134	536182

GS Milling Collets



	I.D.	GS 3/4" Code No.	GS 1" Code No.	GS 1 1/4" Code No.
Metric				
	6mm	534668	534702	534740
	7mm	534670	-	-
	8mm	534672	534704	534742
	10mm	534674	534706	534744
	12mm	534676	534708	534746
	14mm	534678	534710	534748
	16mm	534680	534712	534750
	18mm	-	534714	-
	20mm	-	534716	534752
	25mm	-	-	534754
Inch				
	1/8	534650	534682	-
	3/16	331469N	534684	331481N
	1/4	331470N	534686	331482N
	5/16	331472N	534688	331484N
	3/8	331474N	534690	331486N
	7/16	534660	534692	534726
	1/2	331476N	534694	331488N
	9/16	331477N	-	331489N
	5/8	331478N	534696	331490N
	3/4	-	534698	331492N
	7/8	-	-	331494N
	1	-	-	331496N

Milling Chuck Replacement Parts



Part	Series	Description	Code No.
Replacement Milling Chuck Wrenches			
	GS 3/4	3/4" Chuck Cap	534208
	GS 1	1" Chuck Cap	534210
	GS 1-1/4	1-1/4" Chuck Cap	534212



Solid Carbide End Mills

Compare GS Tooling End Mills with other brands... the biggest difference you'll find is unrivaled value for your money!



Collet Holder Tooling Systems

Type 25 & Type 32 Collets



Type 25 have a collapsibility of 0.2mm
Type 32 have a collapsibility of 0.3mm

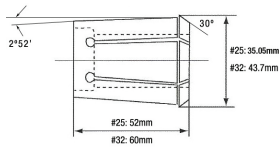

Size (in.)	Type 25 Code No.	Type 32 Code No.
Inch		
1/8	336400	-
3/16	336402	-
1/4	336404	336430
5/16	336406	336432
3/8	336408	336434
7/16	336409	336436
1/2	336410	336438
9/16	336411	336440
5/8	336412	336442
11/16	-	336444
3/4	336414	336446
13/16	-	336448
7/8	336416	336450
15/16	-	336452
1	336418	336454
1-1/8	-	336456
1-1/4	-	336458
Metric		
3 mm	336504	-
4 mm	336506	-
5 mm	336508	336549
6 mm	336510	336550
7 mm	336512	336552
8 mm	336514	336554
9 mm	336516	336556
10 mm	336518	336560
11 mm	336520	336562
12 mm	336522	336564
13 mm	336524	336566
14 mm	336526	336568
15 mm	336528	336570
16 mm	336530	336572
17 mm	336532	336574
18 mm	336534	336576
19 mm	336536	336578
20 mm	336538	336580
21 mm	336540	336582
22 mm	336542	336584
23 mm	336544	336586
24 mm	336546	336588
25 mm	336548	336590
26 mm	-	336592
28 mm	-	336596
29 mm	-	336597
30 mm	-	336598
32 mm	-	336600

Emergency Type Collet



Nylon that can be bored to custom internal diameters to hold unusual sized workpieces.

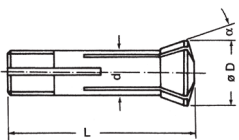

Model	Length (mm)	D (mm)	d (mm)	Head Angle α	Code No.
VE-5CN	87	37.5	31.75	10°	325312

5C Collets



Made of tool steel, hardened and ground to maintain original accuracy.

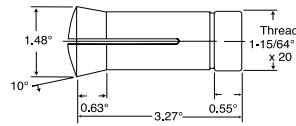

Size (in.)	STM Code No.	GS Code No.
1/8	325315	325317
3/16	325320	325322
1/4	325325	325327
5/16	325330	325332
3/8	325335	325337
7/16	325340	325342
1/2	325345	325347
9/16	325350	325354
5/8	325355	325357
11/16	325360	325362
3/4	325365	325367
13/16	325370	325372
7/8	325375	325377
15/16	325380	325382
1	325385	325387
5C Collet Set 1/8-1"	325310	-

R8 Collets



Manufactured of hardened and ground tool steel, these collets can be recommended for their accuracy and fine finish.

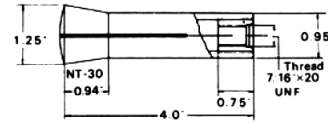

Size (in.)	STM Code No.	GS Code No.
1/8	325165	325167
5/32	325170	325172
3/16	325175	325177
7/32	325180	325182
1/4	325185	325187
9/32	325190	325192
5/16	325195	325197
11/32	325200	325202
3/8	325205	325207
13/32	325210	325212
7/16	325215	325217
15/32	325220	325222
1/2	325225	325227
9/16	325230	325232
19/32	325235	325237
5/8	325240	325242
21/32	325245	325247
11/16	325250	325252
23/32	325255	325257
3/4	325260	325262
R8 Collet Set 1/8-3/4"	325300	-

SOWA TOOLING YOUR WORLD.

Sowa has your tooling needs covered.

Workholding
Indexable Cutting Tools
Tool Holding
Measuring & Inspecting
Accessories
and more!



Retention Knobs

Ground Pilot and Flat

O-Ring on Pilot to prevent coolant penetration into the spindle

Can't find your retention knob?

We invite your inquiries, call 1-800-265-8221 or email sales@sowatool.com.

Please have the following information ready when calling:

1. Taper of Machine
2. Make and Model No. of the Machine
3. Draw Bar Thread Diameter and Pitch
4. Taper Angle required underneath head of stud

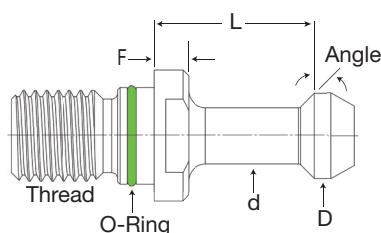



Taper	Model	Coolant Through	D	d	L	F	Angle	Thread	Code No.
BT30	GS585X45	N	0.433	0.276	0.709	0.197	45	M12x1.75	366000
BT30	GS585X60	N	0.433	0.276	0.709	0.197	60	M12x1.75	366002
BT40	PS444X15	N	0.748	0.551	0.905	0.275	15	M16x2	366003
BT40	GSC444X15	Y	0.748	0.551	0.905	0.275	15	M16x2	366004
BT40	GS444X45	N	0.590	0.390	1.102	0.236	45	M16x2	366006
BT40	GS444X60	N	0.590	0.390	1.102	0.236	60	M16x2	366008
BT40	PS444X90	N	0.590	0.390	1.102	0.236	90	M16x2	366010
BT40	GSC444X45	Y	0.590	0.390	1.102	0.236	45	M16x2	366012
BT40	GSC444X60	Y	0.590	0.390	1.102	0.236	60	M16x2	366014
BT40	PSC444X90	Y	0.590	0.390	1.102	0.236	90	M16x2	366016
BT40	PS477	N	0.740	0.490	0.552	0.236	45	M16x2	366018
BT40	PSC478	Y	0.740	0.490	0.440	0.120	45	M16x2	366020
BT40	PSC479	Y	0.740	0.490	0.552	0.120	45	M16x2	366022
BT40	GSC477	Y	0.740	0.490	0.552	0.236	45	M16x2	366024
BT40	PSC480X15	Y	0.748	0.551	0.900	0.157	15	M16x2	366026
BT40	PS534X45	N	0.590	0.390	0.990	0.236	45	M16x2	366028
BT40	PS554	N	0.594	0.406	1.250	0.187	45	M16x2	366030
BT40	PSC554	Y	0.594	0.406	1.250	0.187	45	M16x2	366032
CT40	GSC470X15	Y	0.748	0.551	0.787	0.157	15	5/8x11	366034
CT40	GS474	N	0.740	0.490	0.440	0.118	45	5/8x11	366036
CT40	GSC474	Y	0.740	0.490	0.440	0.118	45	5/8x11	366038
CT40	GSC475	Y	0.740	0.490	0.440	0.120	45	5/8x11	366040
CT40	GS475	N	0.740	0.490	0.440	0.120	45	5/8x11	366042
CT40	PS498	N	0.590	0.390	0.777	0.200	90	5/8x11	366044
CT40	PS531X45	N	0.590	0.390	1.000	0.236	45	5/8x11	366046
CT40	GS532X15	N	0.748	0.551	0.792	0.275	15	5/8x11	366048
CT40	GS532X45	N	0.590	0.390	0.990	0.236	45	5/8x11	366050
CT40	GS532X60	N	0.590	0.390	0.990	0.236	60	5/8x11	366052
CT40	GS532X90	N	0.590	0.390	0.990	0.236	90	5/8x11	366054
CT40	GSC532X15	Y	0.748	0.551	0.792	0.275	15	5/8x11	366056
CT40	GSC532X45	Y	0.590	0.390	0.990	0.236	45	5/8x11	366058
CT40	GSC532X60	Y	0.590	0.390	0.990	0.236	60	5/8x11	366060
CT40	GSC532X90	Y	0.590	0.390	0.990	0.236	90	5/8x11	366062
CT40	PS552	N	0.594	0.406	1.139	0.187	45	5/8x11	366064
CT40	PSC552	Y	0.594	0.406	1.139	0.187	45	5/8x11	366066
CT40	GS572X45	N	0.590	0.390	0.990	0.120	45	5/8x11	366068
CT40	PS572X60	N	0.590	0.390	0.990	0.120	60	5/8x11	366070
CT40	PS572X90	N	0.590	0.390	0.990	0.120	90	5/8x11	366072
CT40	PSC572X45	Y	0.590	0.390	0.990	0.120	45	5/8x11	366074
CT40	PSC572X60	Y	0.590	0.390	0.990	0.120	60	5/8x11	366076
CT40	PSC572X90	Y	0.590	0.390	0.990	0.120	90	5/8x11	366078
CT45	PSC375	Y	0.940	0.605	0.580	0.160	45	3/4x10	366080
BT50	PSC278	Y	1.140	0.820	0.700	0.200	45	M24x3	366082
BT50	GS446X45	N	0.906	0.669	1.378	0.394	45	M24x3	366084
BT50	PS446X60	N	0.906	0.669	1.378	0.394	60	M24x3	366086
BT50	PS446X90	N	0.906	0.669	1.378	0.394	90	M24x3	366088
BT50	GSC446X45	Y	0.906	0.669	1.378	0.394	45	M24x3	366090
CT50	GS275	N	1.140	0.820	0.700	0.200	45	1x8	366092
CT50	PSC274	Y	1.140	0.820	0.700	0.200	45	1x8	366094
CT50	GSC275	Y	1.140	0.820	0.700	0.200	45	1x8	366096
CT50	GS536X45	N	0.906	0.669	1.386	0.394	45	1x8	366098
CT50	GS536X60	N	0.906	0.669	1.386	0.394	60	1x8	366100
CT50	GS536X90	N	0.906	0.669	1.386	0.394	90	1x8	366102
CT50	GSC536X45	Y	0.906	0.669	1.386	0.394	45	1x8	366104
CT50	GSC536X60	Y	0.906	0.669	1.386	0.394	60	1x8	366106
CT50	GSC536X90	Y	0.906	0.669	1.386	0.394	90	1x8	366108

Tool Holder Tightening Fixtures/Setting Stands

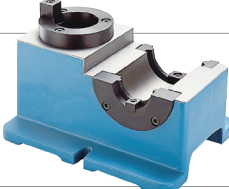

Quick and easy way to change cutters and retention knobs safely. Protects the taper of holder with protective insert.

	Vertical Description	Horizontal Description	Code No.
Deluxe Tool Holder Tightening Fixtures  <p>Select between horizontal or vertical tool holding; quick and simple operation</p> 	40 Taper (CAT, BT & NMTB)	40 Taper x 2 (only BT & NMTB)	335250
	50 Taper (CAT, BT & NMTB)	50 Taper x 2 (only BT & NMTB)	335260
	50 Taper (CAT, BT & NMTB)	50 Taper x 1 / 40 Taper x 1	335240
	40 Taper (CAT, BT & NMTB)	50 Taper x 1 / 40 Taper x 1	335230

Simple Tool Holder Tightening Fixtures  	30 Taper (CAT, BT & NMTB)	-	335200
	35 Taper (CAT, BT & NMTB)	-	335205
	40 Taper (CAT, BT & NMTB)	-	335210
	50 Taper (CAT, BT & NMTB)	-	335220

Simple Tool Holder Tightening Fixtures 	30 Taper (CAT, BT & NMTB)	-	335270
	40 Taper (CAT, BT & NMTB)	-	335275
	50 Taper (Only CAT50 & NMTB50)	-	335280

NC/CNC Tool Trolley Cart



Complete Tool Trolley with 4 Tool Trays that bolt in and Inserts.

- (W)1002mm x (D)650mm x (H)830mm
- Weight: 51kgs



Description	Tool Cart Code No.	Replacement Plastic Inserts Code No.
40 Taper Type Trolley with 7 inserts per tray (4 trays hold 28 inserts)	326985	326986
50 Taper Type Trolley with 5 inserts per tray (4 trays hold 20 inserts)	326995	326996

Spindle Taper Wipers



- For easily and quickly cleaning spindle holes
- Plastic body, the taper wiper is made of special cotton material therefore not damaging the spindle
- The BT & DIN tapers are the same



Model No.	Taper	Total Length	Code No.
VTW-30	#30	168mm	326210
VTW-40	#40	159mm	326215
VTW-50	#50	265mm	326220

HSK Accessories



HSK Coolant Tube Wrenches

Part	Series	Description	Code No.
	HSK63A	Coolant Tube Wrench	536604
	HSK100A	Coolant Tube Wrench	536606

Designed to lock and unlock the HSK coolant supply units

HSK Coolant Tubes

Designed specifically to be used with HSK holders
Leak-proof screwed connection

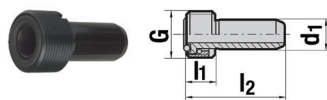

Used with Taper	d1	G	l1	l2	Code No.
HSK63A	12	M18x1	11.5	36.5	536600
HSK100A	16	M24x1.5	15.5	44.0	536602

HSK Spindle Taper Wipers



Model No.	Taper	Total Length	Code No.
VTW-50H	HSK50	159mm	326225
VTW-63H	HSK63	167mm	326230

HSK Simple Tool Holder Tightening Fixture



Taper	Description	Code No.
HSK63	Tool Setting Stand, Weight 4.5 kg	335225



Superior performance tooling solutions when speed and accuracy matter most.

GS Tooling is an industry leader in precision tooling where high-performance and stringent quality standards are essential. Tool Your World with GS Tooling End Mill Holders, Collet Chucks & Collets, Shrink Fit Solutions, Retention Knobs, Vises & Workholding, Live Centers, Angle Heads, Carbide End Mills and more!



Shop
GS Tooling



Tool Holding



Angle Heads & Driven Tooling



Cutting Tools

Shrink Fit Solutions

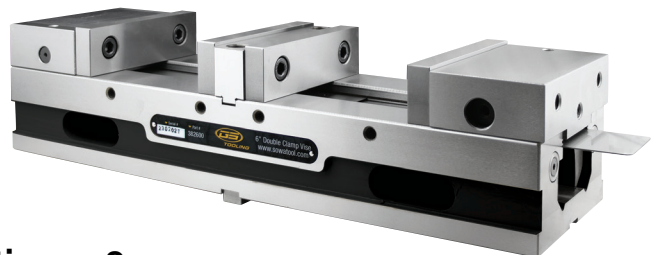

Vises & Workholding



SOWA's complete line of metalworking solutions



Sowa Tool's premium brand delivers top-tier quality and performance that rivals or exceeds the best in the world. These products offer premium features and dependability, at shockingly affordable prices, making them an ideal choice for applications where accuracy and speed matter most.

ASIMETO

Sowa's family of metrology solutions deliver absolute confidence born from its European engineering, and each tool beginning its journey in our ISO 17025 accredited labs. This premium heritage product priced at a non-premium price, delivers significant value for your money.



With our Sowa branded tools, we bring to our customers high performance cutting tools engineered to deliver superior tool life, machining efficiency & quality while still offering maximum value for your money.

SKODA

Sowa Tool's exclusive line of general-purpose live centres with its roots in European quality that deliver excellent accuracy, rigidity, and durability at a price point that suits most budgets. Sowa carries a wide range of in-stock standard models to suit most common turning applications.



Sowa Tool's exclusive line of European universal boring and facing heads offer superior accuracy and precision for all your facing and boring applications. They feature an easy-to-adjust design, durable castings, and precision spindle bearings for a consistently accurate finish.



Our approach to this brand ensures that our customers receive the best value for their investment by delivering a broad assortment of metalworking tools at an exceptional price. These tools typically apply to less demanding applications seen on the standard shop floor where the cost of the tool has the greatest influence on the selection process.



At Sowa Tool & Machine

we understand the needs of machining processes, and our extensive product lines offer a comprehensive solution. Our goal is to provide customers with the cost benefits of a single-source supplier, while remaining committed to delivering the highest quality products.

Ask for them by name!



Shop Online:

www.SowaTool.ca

sales@sowatool.com

TF: 1-800-265-8221